



LONGBOARD®
INSPIRING ARCHITECTURE

Tongue & Groove Planks Textured Cladding

Installation Guidelines



Table of Contents

| | |
|---|-----------|
| Material Specifications | 3 |
| Finishes | 3 |
| Material ordering and deliveries | 3 |
| Storage and handling | 3 |
| Cleaning Recommendations | 3 |
| Warranty | 4 |
| Graffiti Removal | 4 |
| Components | 5 |
| Components (Typical) | 5 |
| Tools/Cutting/Fastening | 6 |
| Tools | 6 |
| Cutting | 6 |
| Fastening | 7 |
| Fastener types | 7 |
| Fastening options onto exterior insulation | 7 |
| Framing requirements | 8 |
| Furring recommendations | 8 |
| System Install | 9 |
| Perimeter area and field limitations | 9 |
| Component assembly | 10 |
| Bevel Planks | 10 |
| Castellation Planks | 11 |
| Castellation Planks with Link & Lock | 12 |
| Plank Install | 12 |
| Link & Lock Install | 13 |
| Details | 14 |
| Single Butt-Joints | 14-15 |
| Multiple Floating Butt-Joints | 16 |
| Appendix | 17 |
| Tables 1&2 - Expansion & contraction | 17 |
| Tables 3&4 - Quick Screen Clip/wind load -Starter | 18 |
| Tables 5-8 - Link & Lock Allowable Span | 19 |
| Handling and care of products | 20 |
| Blank page | 21 |
| Contact Info | 22 |

Material Specifications

Finishes

- Longboard Products are available in a wide range of powder coated finishes.
- Custom solid colors are available upon request.
- Longboard woodgrains have a repeat pattern, shipped in sets mated back-to-back in each box. Install these as they come out of the box, as an A&B pattern staggering each plank approx. 1-2' (305-610mm) from the previous plank to achieve a random pattern aesthetic. It is recommended to create an onsite mock-up to produce a suitable pattern.
- Woodgrains NOT available for the Triple Bevel Plank
- All Castellations Planks in woodgrain require L&L attached.
- Longboard Products are not recommended for use on marine applications in direct contact with salt water.

Longboard extruded products are produced 1" (25mm) oversized, as one end is drilled for the coating process, and both ends have 1/2" (12mm) of masking tape (woodgrains only) which must be cut off for best results. Longboard Cladding is to be installed outboard of a weather resistant barrier, including all flashings, following code, and building requirements.

Material Ordering & Delivery

-
- **Packaging:** Planks are sold in box quantities:
6" Bevel Planks: 96 SQ FT/Box (8/24's, 192 LF) w. 90pcs Quick-Screen Clips included
4" Castellations Planks: 96 SQ FT/Box (12/24's) w. 144 Quick-Screen Clips included
8" Castellations Planks: 96 SQ FT/Box (6/24's) w. 72 Quick-Screen Clips included
Components are sold individually by the 12' (3.7m) length.
-
- **Shipping:** Most Popular Finishes -ready to ship within 1 week
Additional Finishes -ready to ship within 14 weeks
Delivered on 24' (7.3m) long skids weighing up to 2000 lbs. A mechanical lift with forks is required on site to receive the order.
-
- **QC:** Always inspect the delivery for damage and contact LB ASAP if there are any issues: info@longboardproducts.com or 1-800-604-0343 and include your PO# and any pictures if possible. Mark the delivery receipt as "damaged" and accept the delivery as-is. Longboard is not responsible for the installation of blemished or damaged material.

Storage & Handling

Be sure to store the material flat, keep it dry, safe & secure and remain in unopened cartons until ready to be installed. **See Appendix for proper handling and care instructions.**

Cleaning Recommendations

- Initial and periodic cleaning for best looking product
- Basic methods use a combination of moderate water pressure, soft sponge/brush and a mild detergent (Safe for your hands, safe for the product)

⚠ **NEVER** use aggressive acid or alkaline cleaners on Longboard finishes. Do not use cleaners containing Trisodium Phosphate, Phosphoric Acid, Hydrochloric Acid, Hydrofluoric Acid, Fluorides, or any other compound that is known to react with metal.

***See Cleaning Guide for full requirements & cleaning schedule:**

longboardproducts/resources/care-maintenance.com

Warranty

Upon substantial completion of the project, register for warranty online here: longboardproducts.com/warranty

⚠ Registration is required for the warranty to be in effect.

- To be covered by warranty Castellations Planks shall be installed vertically, to limit standing water **as per Clause 4.4 of the Pinnacle Warranty Document**



Graffiti Removal

Standard Woodgrain 

Use Standard soap & water only

D2000 Solid Color

| | Prosoco Cleaner | MEK Solvent |
|-------------------------|-------------------------------------|-------------------------------------|
| Permanent Marker | <input checked="" type="checkbox"/> | <input checked="" type="checkbox"/> |
| Oil Based Spray Paint | <input checked="" type="checkbox"/> | <input checked="" type="checkbox"/> |
| Water Based Spray Paint | <input checked="" type="checkbox"/> | <input checked="" type="checkbox"/> |
| Adhesive Tape | <input checked="" type="checkbox"/> | <input checked="" type="checkbox"/> |

 MEK Solvent
 Prosoco Anti-Graffiti Cleaner

SPECIAL ORDER - EXT. LEAD TIMES CONTACT LB

Anti-Graffiti High Gloss Woodgrain

| | MEK Solvent |
|-------------------------|-------------------------------------|
| Permanent Marker | <input checked="" type="checkbox"/> |
| Oil Based Spray Paint | <input checked="" type="checkbox"/> |
| Water Based Spray Paint | <input checked="" type="checkbox"/> |
| Adhesive Tape | <input checked="" type="checkbox"/> |

 MEK Solvent

Note: Cleaning the surface with a cleanser that is not diluted as per instructions may result in damage to the coating.

Components

Components (Typical)

Textured Wall planks are used in conjunction with T&G components. For all LB components go to longboardproducts.com.

Bevel Planks

| Size | 12' * | 24' * | 12' Perf * | 24' Perf * |
|------------------|---------|---------|------------|------------|
| 6" Single | 6SB.145 | 6SB.289 | - | - |
| 6" Triple | 6TB.145 | 6TB.289 | - | - |

Castellation Planks

| Size | 12' * | 24' * | 12' Perf * | 24' Perf * |
|-----------|---------|---------|------------|------------|
| 4" | 4CA.145 | 4CA.289 | - | - |
| 8" | 8CA.145 | 8CA.289 | - | - |

Accessories

| Product | Qty | SKU |
|---|--------------|------------|
| Quick Screen Clips | 1750, box | CLIP.N1750 |
| Quick Screen Clips | 100, bag | CLIP.N100 |
| 1/16" U-SHIM | 250, bag | SHIM.1001 |
| Butt-Joint Fastening Kit (6") | 20 kits, bag | TGBJKIT |
| Touch Up Pens <i>Reach out to confirm color with account manager.</i> | N/A | TUP |

Trim Components

| Type | Style | Product | Dimensions | SKU |
|---------------------------|-------------|--|----------------|------------|
| Starter | Precision | Starter J-Track | (5/8") - 12' | 1SJT.145 |
| Starter | Traditional | Starter Strip | (1-7/8") - 12' | 2SS.145 |
| Starter | Traditional | Back-to-Back Starter Strip | (1-1/4") | 2BTBSS.145 |
| J-Track | Precision | Two Piece J-Track | (5/8") - 12' | 1X1JT.145 |
| J-Track | Precision | J-Track | (5/8") - 12' | 1JT.145 |
| J-Track | Craftsman | J-Track | (7/8") - 12' | JT23.145 |
| J-Track | Craftsman | Two Piece J-Track | (7/8") - 12' | JT23S.145 |
| J-Track | Traditional | Two Piece J-Track | (1-3/8") - 12' | 1X2JT.145 |
| Corner | Precision | Outside Corner | (3/16") - 12' | 05OC.145 |
| Corner | Craftsman | Inside Corner | (3/4") - 12' | 1IC.145 |
| Corner | Craftsman | Outside Corner | (1") - 12' | 1OC.145 |
| Corner | Traditional | Corner Set | (2") - 12' | 2CORS.145 |
| Corner | Traditional | 3" Smooth | (3") - 24' | 3SCP.289 |
| Corner | Traditional | 3" V-Groove | (3") - 24' | 3VGP.289 |
| Reveal | Precision | Flat Reveal | (1/2") - 12' | 1FR.145 |
| Reveal | Precision | T&G Flat Reveal | (1/2") - 24' | 1TGR.289 |
| Reveal | Craftsman | U-Reveal Set | (3/4") - 12' | 1URS.145 |
| Reveal | Craftsman | T&G U-Reveal | (3/4") - 24' | 1TGURK.289 |
| Reveal | Traditional | U-Reveal Set | (1-1/2") - 12' | 2URS.145 |
| Reveal | Traditional | Flat Reveal Set | (1-1/2") - 12' | 2FRS.145 |
| Reveal | Traditional | T&G U-Reveal | (1 1/2") - 24' | 2TGURK.289 |
| Reveal | Traditional | Offset Flat Reveal Set, J-Track Base | (2") - 12' | 2OFFJ.145 |
| Reveal | Traditional | Offset Flat Reveal Set, Termination Base | (2") - 12' | 2OFFT.145 |
| Termination | Precision | Termination Set | (5/8") - 12' | 1TS.145 |
| Termination | Craftsman | Termination Set | (7/8") - 12' | TS23S.145 |
| Termination | Traditional | Termination Set | (1-3/8") - 12' | 2TS.145 |
| Compression Joints | Traditional | Compression Joint | (1-3/8") - 24' | 2CJ.289 |

Bevel Planks

Single Bevel:
Available in all finishes



Triple Bevel:
Available in solid colors only

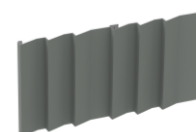

Butt-Joint Fastening Kit

Castellation Planks

Woodgrains:
Link & Lock™ Required



Solid Colors:
Link & Lock™ NOT Required

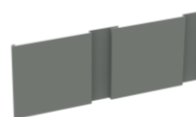



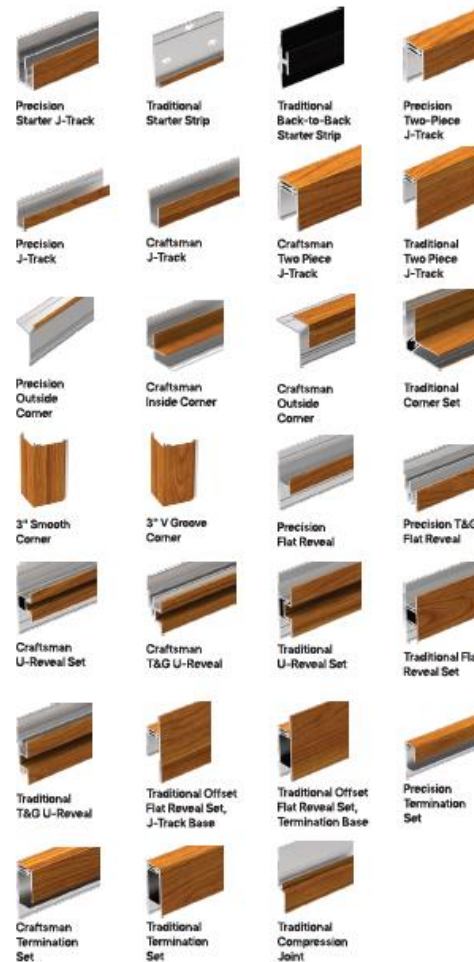



U-Shim

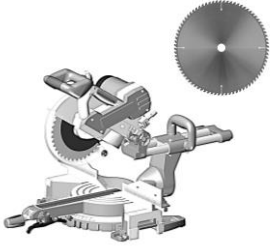

Tools/Cutting/Fastening

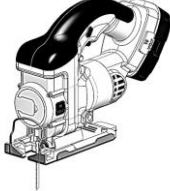
Tools

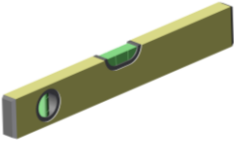
Commonly used tools for Cladding install.

| | | | |
|---|---|--|---|
|  |  |  |  |
| Table Saw with Carbide Metal Blade Non-ferrous 60-80T (for cutting aluminum) | Miter Saw with Carbide Metal Blade Non-ferrous 60-80T (for cutting aluminum) | Cordless Drill with clutch | Jig Saw (for protrusions) |
|  |  |  |  |
| Rubber Mallet (or Hammer) | Level | Hole Saw (for lighting fixtures) | #10 Pan Head Screws <small>*Length, thread and point to suit substrate</small> |

Cutting

⚠ Always be sure to wear appropriate PPE: eye & hearing protection.

Cut planks using a Miter Saw and Table Saw, always allowing for expansion & contraction. Trim the taped/drilled ends of all stock length material by at least **1/2" (12mm) each end** and discard.

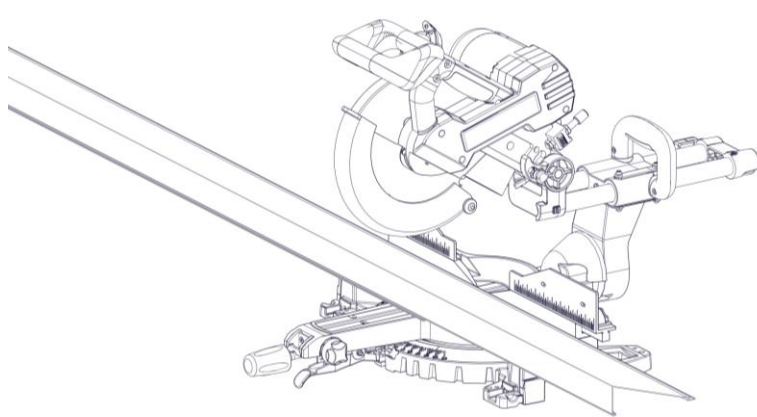

Fastening

Fasteners must be corrosion resistant and comply with all local building codes.

⚠️ All fasteners should be suitable for exterior use and be compatible with the substrate type. **Fasteners should be anchored into a solid secure framing member, blocking, furring, or strapping.** For vertical applications when the framing member is not available, install diagonal furring strips or horizontal metal strapping to securely fasten planks.

Perimeter components should be hard fastened every **16" (406mm) O.C. max.** directly through the flange using #10 pan-head screws (supplied by others). These components should be fastened within **8" (203mm)** of the end for secure fastening.

Planks & starter components are secured using Longboard **Quick-Screen Clips** fastened to the substrate every **16" (406mm) O.C. max** using #10 pan-head screws (supplied by others).

⚠️ Always consult the project engineer, architect or authority having jurisdiction to understand the project specific fastening requirements.

Fastener types

RECOMMENDED

Pan-Head



*Length, thread and point to suit substrate

CORRECT

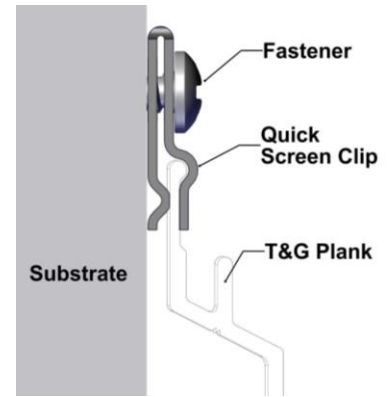

DO NOT USE

Flat-Head Oval-Head

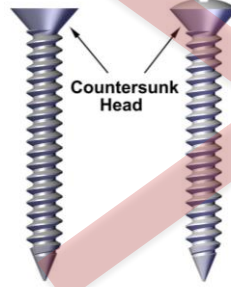

INCORRECT

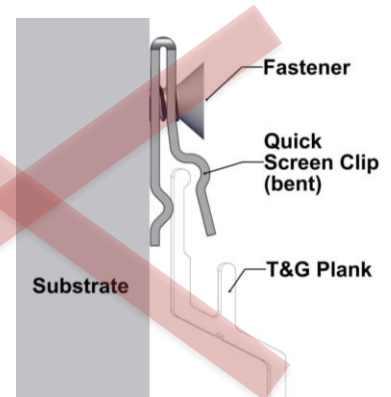

Fastening options onto exterior insulation

*Never direct to insulation. Must be secured directly to solid secure substrate.

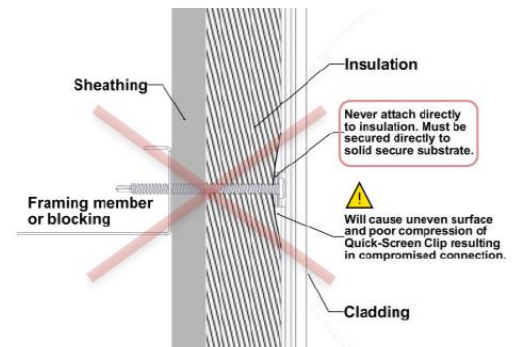
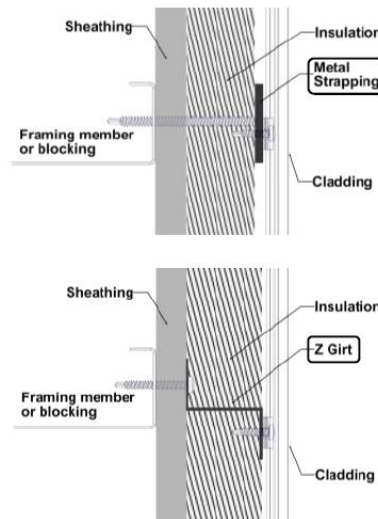
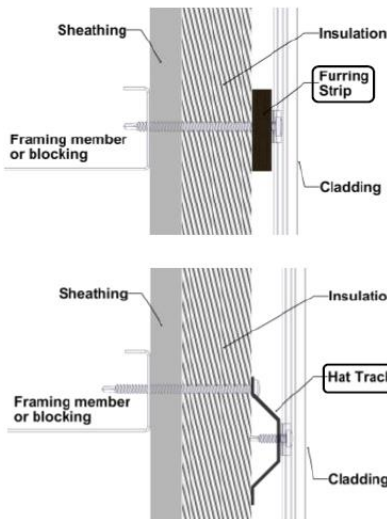

Framing requirements

Always consult the local building authority and follow local building code requirements.

When attaching to **Hitch Cladding attachment System** refer to Hitch Install Guide for requirements.

Wood Framing

- Size: 2x4 minimum
- Spacing: 16" O.C. spacing

Metal Framing

- Gauge: 18 ga. minimum
- Spacing: 16" O.C. spacing

Furring recommendations

Hitch Girts

Attached back to wood or metal framing/blocking.

- Sizes: 3/4", 1"
- Spacing: 16" O.C. spacing

Wood Furring

Attached back to wood or metal framing/blocking.

- Size: 3/8" minimum
- Spacing: 16" O.C. spacing

Metal Furring/Strapping

Attached back to wood or metal framing/blocking.

- Size: 18 ga. minimum
- Spacing: 16" O.C. spacing

Concrete/CMU

Wood or metal furring is recommended over concrete and CMU.

Wood Furring:

- Size: 2x2 minimum
- Type: Pressure treated lumber
- Spacing: 16" O.C. spacing

Metal Furring:

- Size: 18 ga. minimum
- Type: Hat channel, Stud, or Z-Girt.
- Spacing: 16" O.C. spacing

System Install

Perimeter and field area limitations

- Measure and layout your wall area to consider plank & component alignment with fixtures, penetrations, and adjacent walls, for desired appearance. Consider using butt-joints along runs to minimize waste. Apply the same methodology for horizontal Bevel Plank installations.
- To be covered by warranty Castellations Planks shall be installed vertically, to limit standing water **as per Clause 4.4 of the Pinnacle Warranty Document**

Seamless runs up to 24' length planks (no butt-joints).

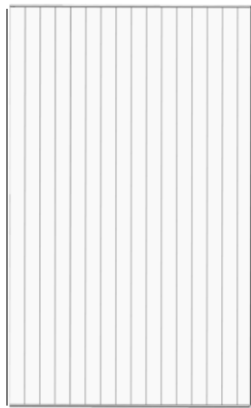

Note: Make sure to leave 1/4" gap at end of plank runs for expansion and contraction.

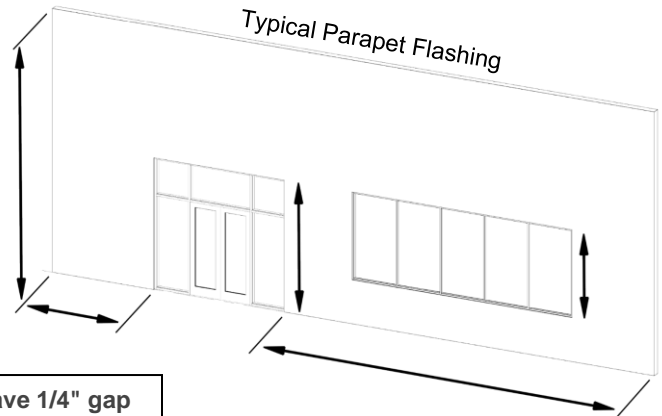

Runs up to 40' length with staggered butt-joints.

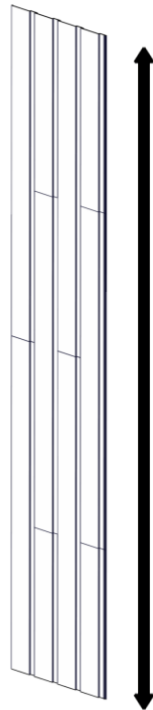

Castellations Planks

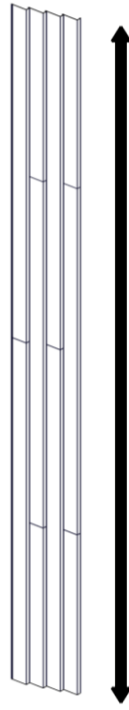

Bevel Planks

Component assembly

Bevel Planks -Single Bevel shown

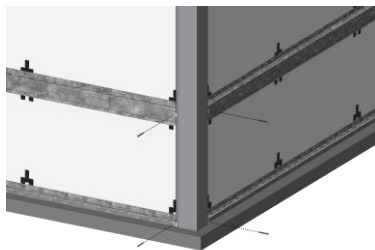
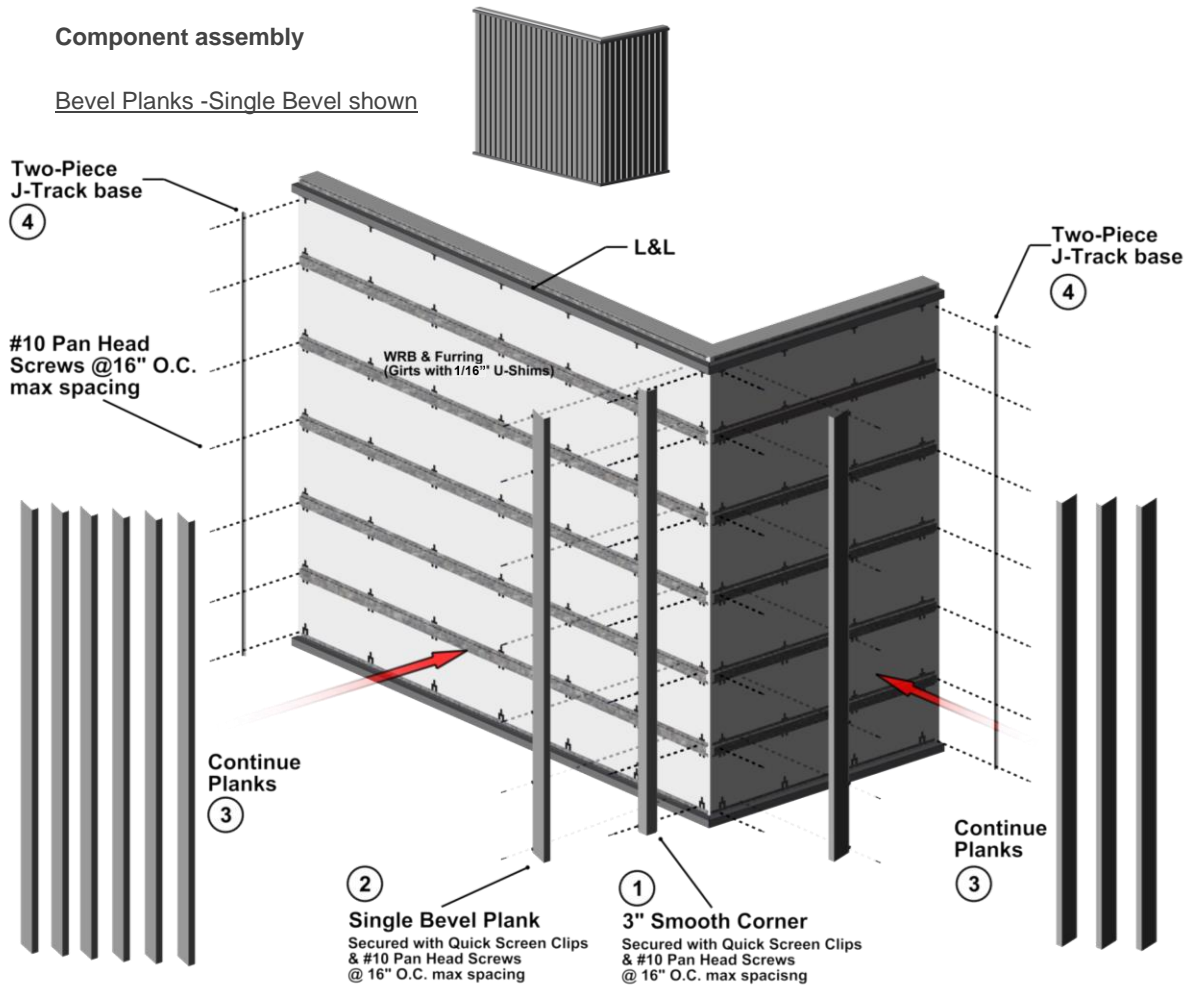

Step 1

Install 3" Smooth Corner with Quick Screen Clips & #10 Pan Head Screws @16" O.C. max spacing. Hard fasten only one point preferably near the center of each plank.

Alternative starting option is to use Starter strip at the edge of the wall(s) fastening #10 Pan Head Screws every 16" O.C. max spacing.

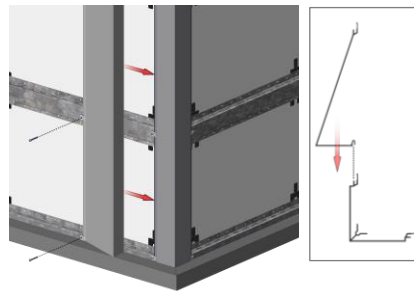

Step 2 & 3

Place the planks fully engaging the tongue. Fasten with Quick Screen Clips & #10 Pan Head Screws @16" O.C. max spacing. Hard fasten only one point preferably near the center of each plank. It is good practice to check your installation every 2-3 rows for level/plumb & flat or straight for best results. Ensure there is sufficient room for expansion & contraction of each Plank.

Confirm cut off Taped/Drilled plank ends (1/2" each end).

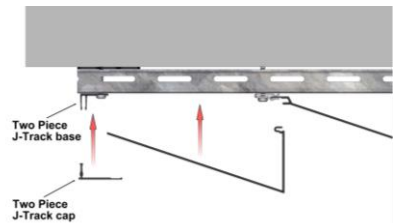

Step 4

Before the last Plank, install Two Piece J-Track base fastening 16" O.C. typ.

When terminating, confirm the trim component caps will cover the last Plank and adjust accordingly to suit the profile.

When all Planks are installed, finish off the trims with caps from two-piece sets.

Castellation Planks -8" Castellationshown

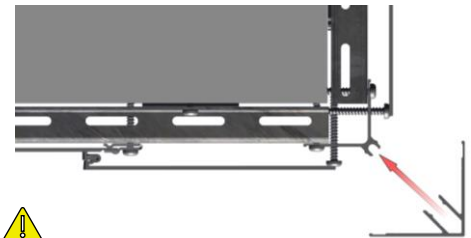
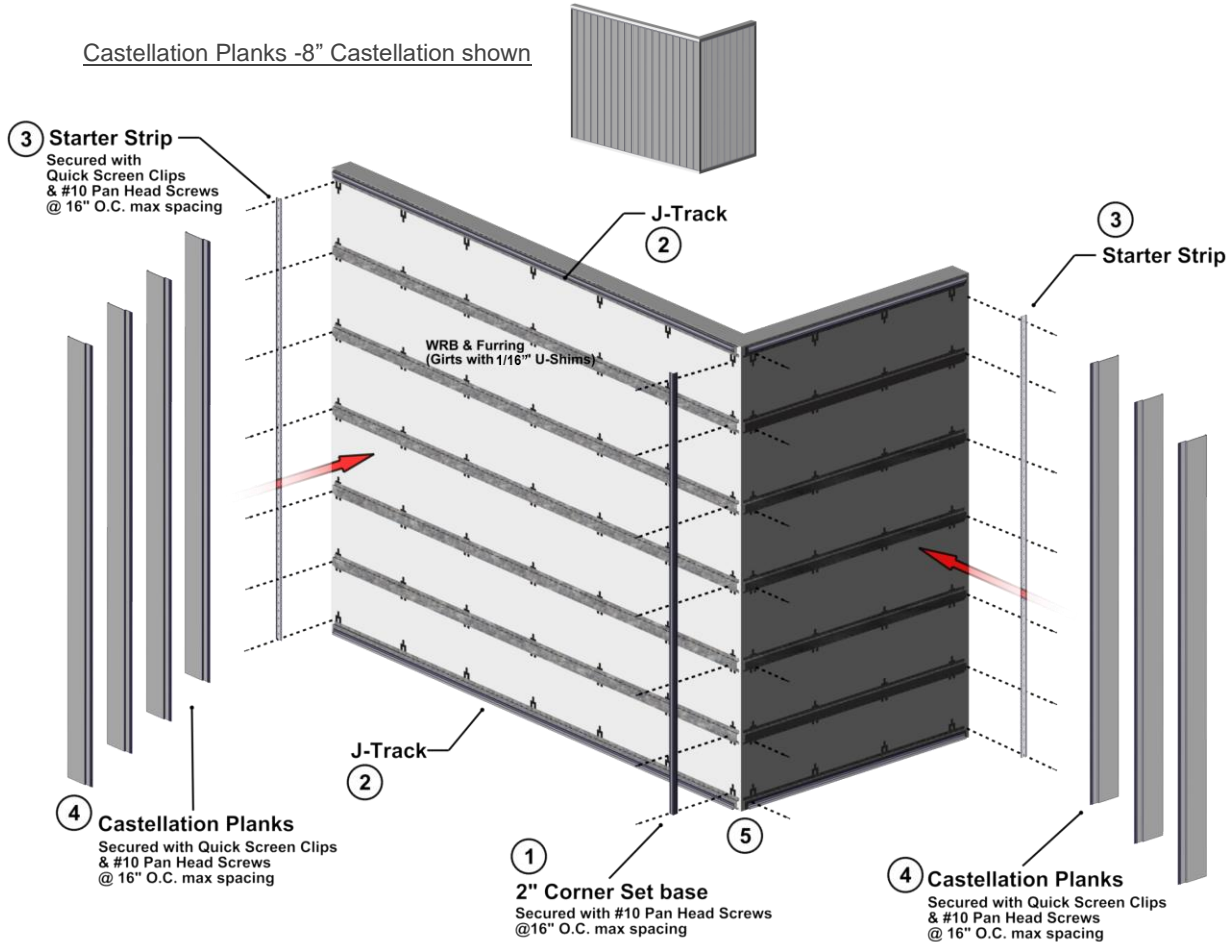

⚠
 Confirm cut off
 Taped/Drilled plank
 ends (1/2" each end).

Step 1 & 2

Install 2" Corner Set base and J-Track (or Two Piece J-Track) with #10 Pan Head Screws @16" O.C. max spacing. Alternative starting option is to use Starter strip at the edge of the wall(s) fastening #10 Pan Head Screws every 16" O.C. max spacing.

Step 3

Install Starter Strip or Starter J-Track at the edge of walls using Quick Screen Clips & #10 Pan Head Screws @16" O.C. max spacing. Hard fasten only one point preferably near the center of each plank. See Appendix for Starter Strip loading.

Step 4 -See Page 12 if installing

Castellation planks with L&L. Place the planks fully engaging the tongue in the Starter. Fasten with Quick Screen Clips & #10 Pan Head Screws @16" O.C. max spacing. Hard fasten only one point near the center of each plank. It is good practice to check every 2-3 rows for level/plumb & flat or straight for best results. Ensure there is sufficient room for expansion & contraction of each Plank.

Step 5

When terminating confirm the trim component caps will cover the last Plank and adjust accordingly to suit the profile. Where terminating cut planks, provide a positive stop approximately every 16" (406mm).
 When all Planks are installed finish off the trims with caps from two-piece sets.

Castellation Planks -with Link & Lock

Plank Install

To prepare Castellation Planks for Link & Lock install:



Step 1

Measure & cut the castellation plank to length and lay plank into place. Adjust for expansion & contraction and confirm that trim components cover the plank (fasten with screw to temporarily hold in place if needed).

Mark out the L&L attachment points at the castellation groove, remove and drill out the plank at these locations.



Confirm cut off Taped/Drilled ends (1/2" each end).

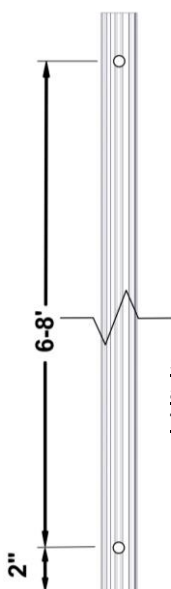

Typical L&L attachment span

See Appendix for the L&L attachment span allowance. Tables 5-8.



Step 2

Replace plank, center the holes at the attachment points and install with Quick Screen Clips, #10 Pan Head Screws and 1/16" Shims. The shims are used to support the L&L install at the attachment point.  Purchased separately.

Repeat these steps for the rest of the Castellation Planks or mark and drill for the desired measurement.

Note: To hard fasten 1 location per length, omit the drilled hole at that location and hard fasten.

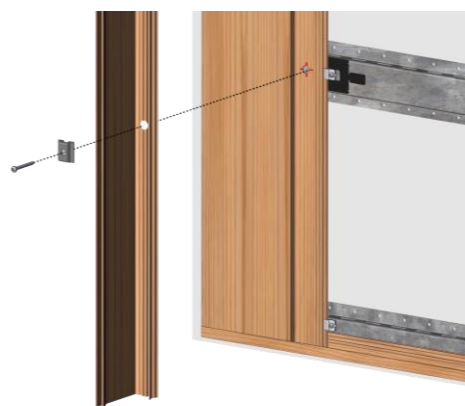

See next page for L&L install steps.

Castellation Planks -with Link & Lock

Link & Lock Install

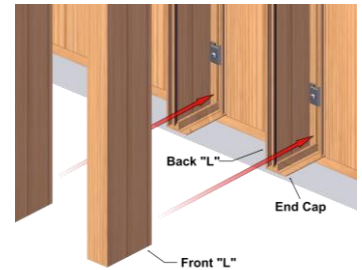
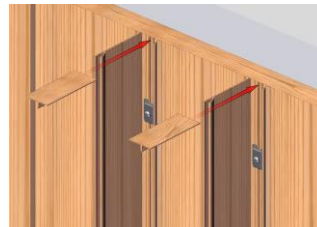
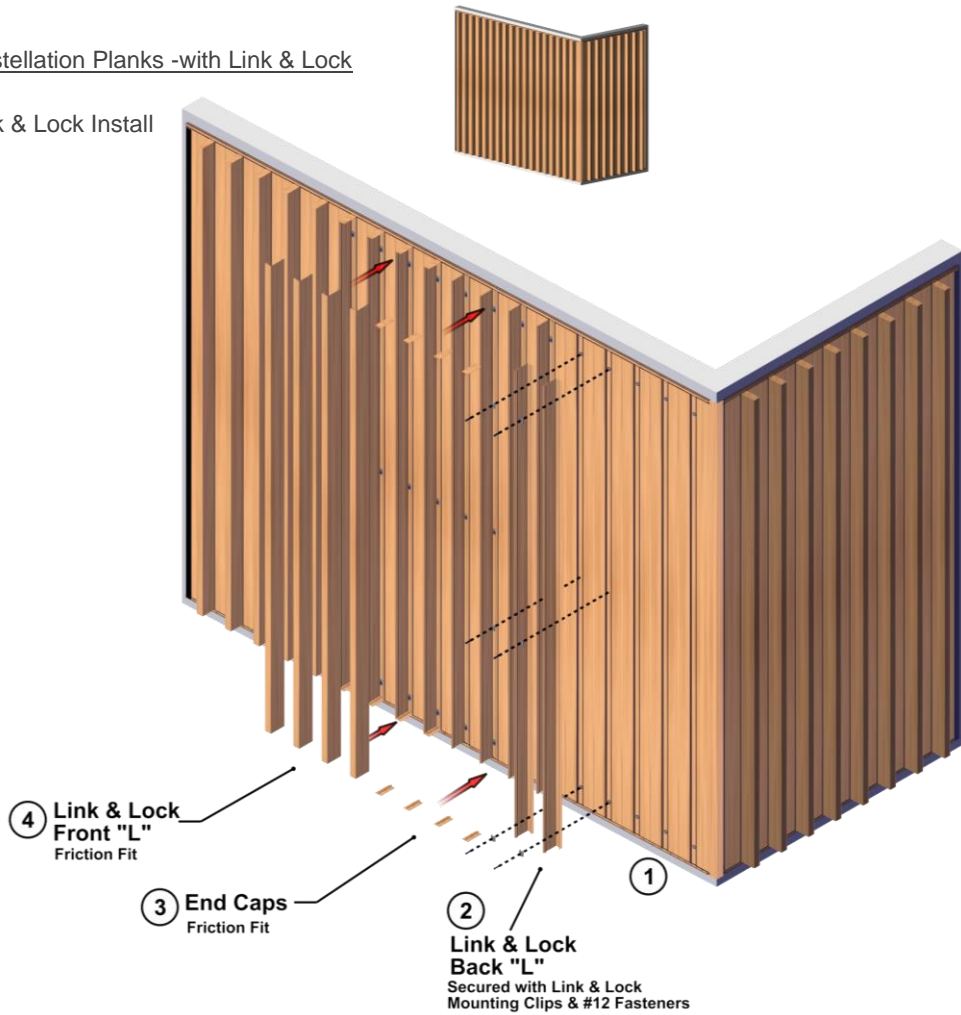

Step 1

Measure, mark and drill out the L&L back "L" for the 1/2" holes to match the Castellations planks.

Step 2

Secure the Back "L" to the Castellations Planks with Link & Lock Mounting Clip & #12 Fasteners. Make sure it aligns and fits into the groove correctly and is anchored into the center of the drilled-out holes. Leave gap for expansion & contraction and End Cap allowance.

Step 3

Install End Caps top & bottom into Back "L" sliding them into the screw chase.

Step 4

Install Front "L" locking it into place. It is good practice to check components for a tight fit.

Details

Single Butt-Joints

- Consider using butt-joints along runs to minimize waste.
- **⚠** When installing staggered butt-joints, use the Butt-Joint Fastening Kit to ensure joints do not open up (See Detail A & B).
Fasteners should be placed at the uppermost location of the plank flange, to not interfere with the next plank engaging the tongue and groove properly. At the butt-joint, fasteners should be anchored into the Butt-Joint backer plate.
- (See Detail C)
- Rivets can be used for single butt-joints, however clearance of the rivets and room for movement is required.
- On exposed cuts such as butt-joints, trim ends or similar, use touch-up paint pens (purchased separately) to finish the ends of the two (2) planks at the butt-joint.
- DO NOT hard-fasten a plank to a component trim, as this will restrict its ability to expand & contract into the component.
- If no butt joints along the length, it is good practice to hard-fasten each plank directly through the flange near the center, to keep the planks from migrating.
- DO NOT hard-fasten more than one (1) location per plank.
- Hard fasten at the butt-joint or the center of each plank run.

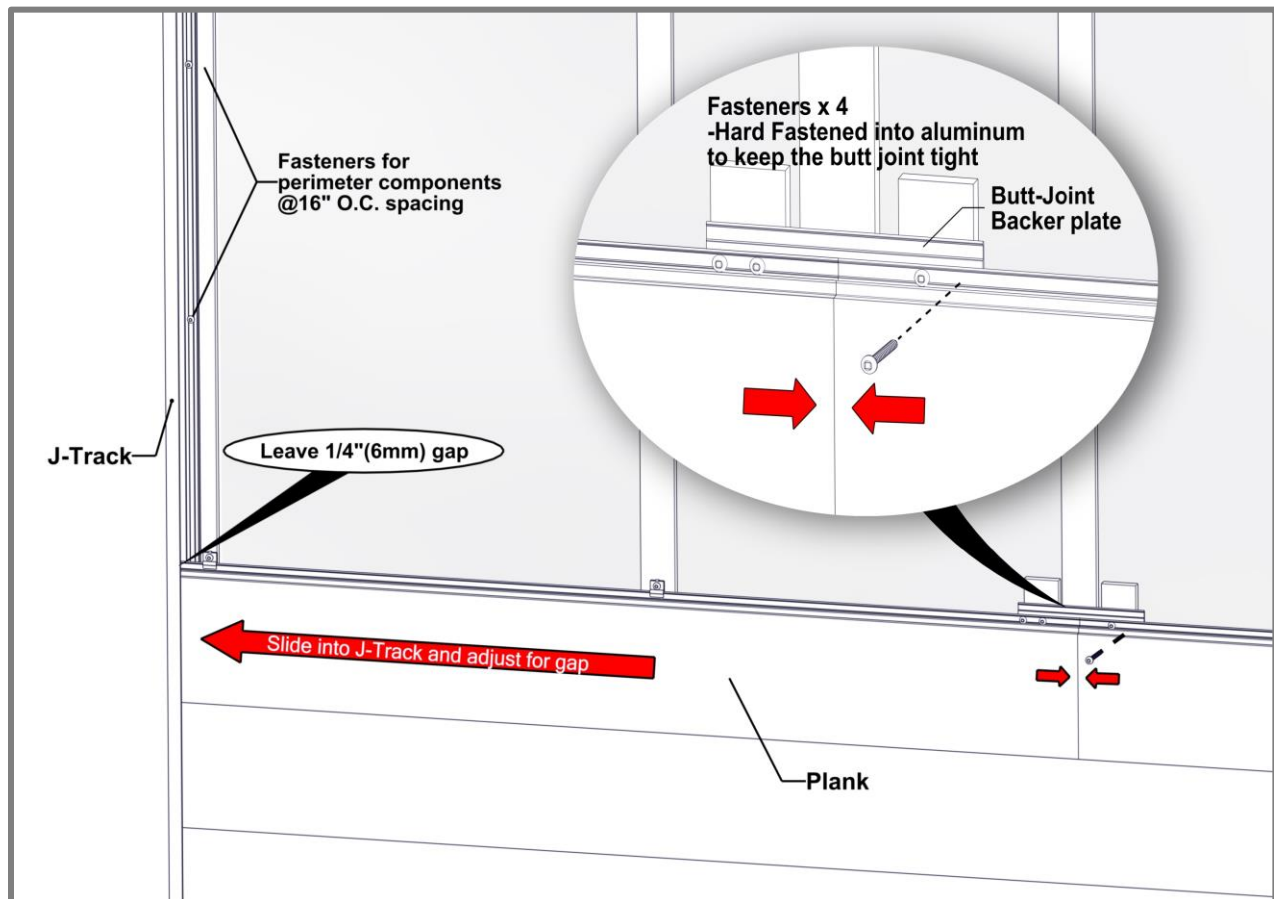

Detail A -Horizontal Cladding

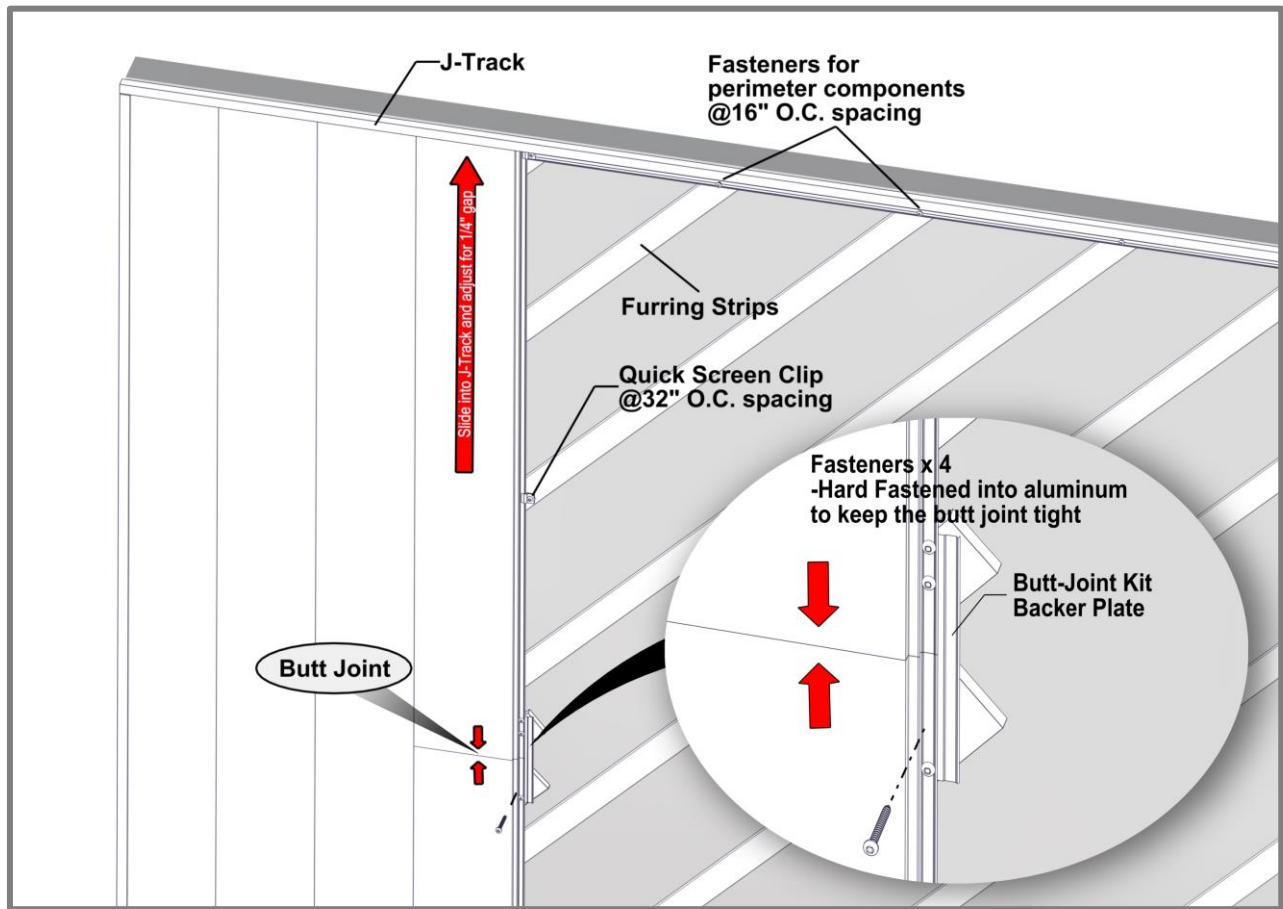

Detail B -Vertical Cladding

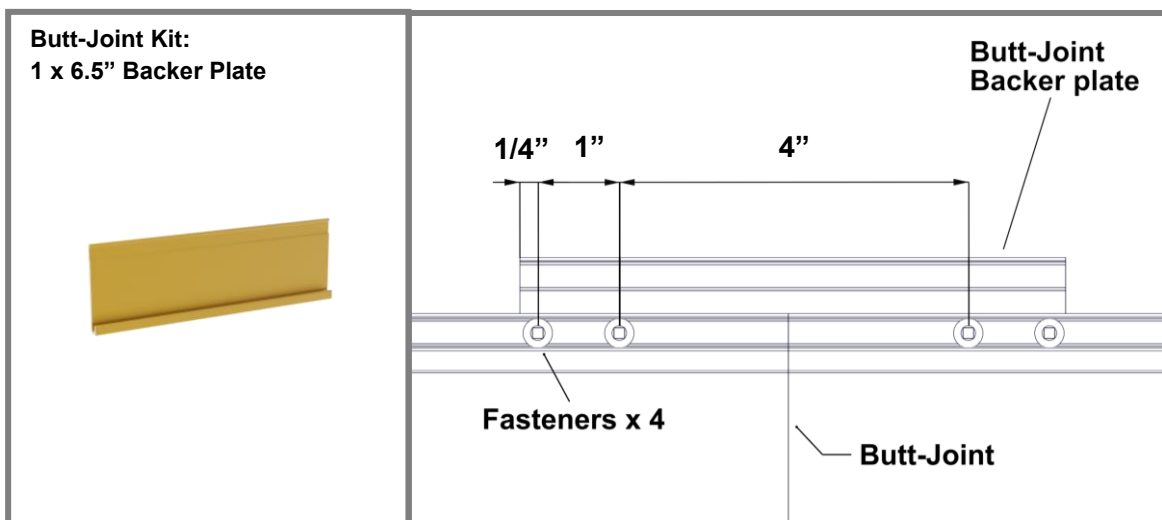

Detail C -Backer Plate (Hard Fastened)

Multiple Floating Butt-Joints

- ⚠ When installing staggered multiple floating butt-joints, use the Butt-Joint Fastening Kit to ensure joints do not open up. Rivets should be placed at the center of the plank flange, to not interfere with the next plank engaging the tongue and groove properly. **(See Detail D)**
- MUST HAVE furring strips or girts to allow room for movement.
- Recommended to be installed between furring strips or framing members to avoid contact which would restrict movement. **(See Detail E)**
- On exposed cuts such as butt-joints, trim ends or similar, use touch-up paint pens (purchased separately) to finish the ends of the two (2) planks at the butt-joint.
- DO NOT hard-fasten a plank to a component trim, as this will restrict its ability to expand & contract into the component.
- DO NOT hard-fasten more than one (1) location per multiple plank run.
- Hard fasten near the center of the multiple plank run.

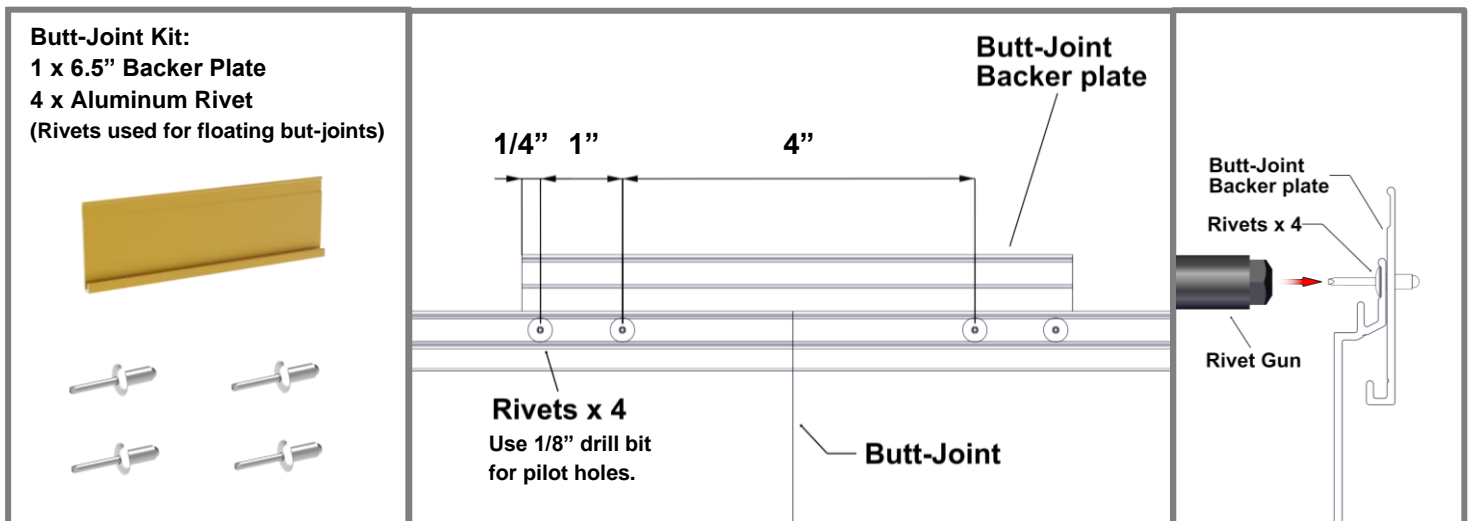

Detail D -Floating Butt-Joint

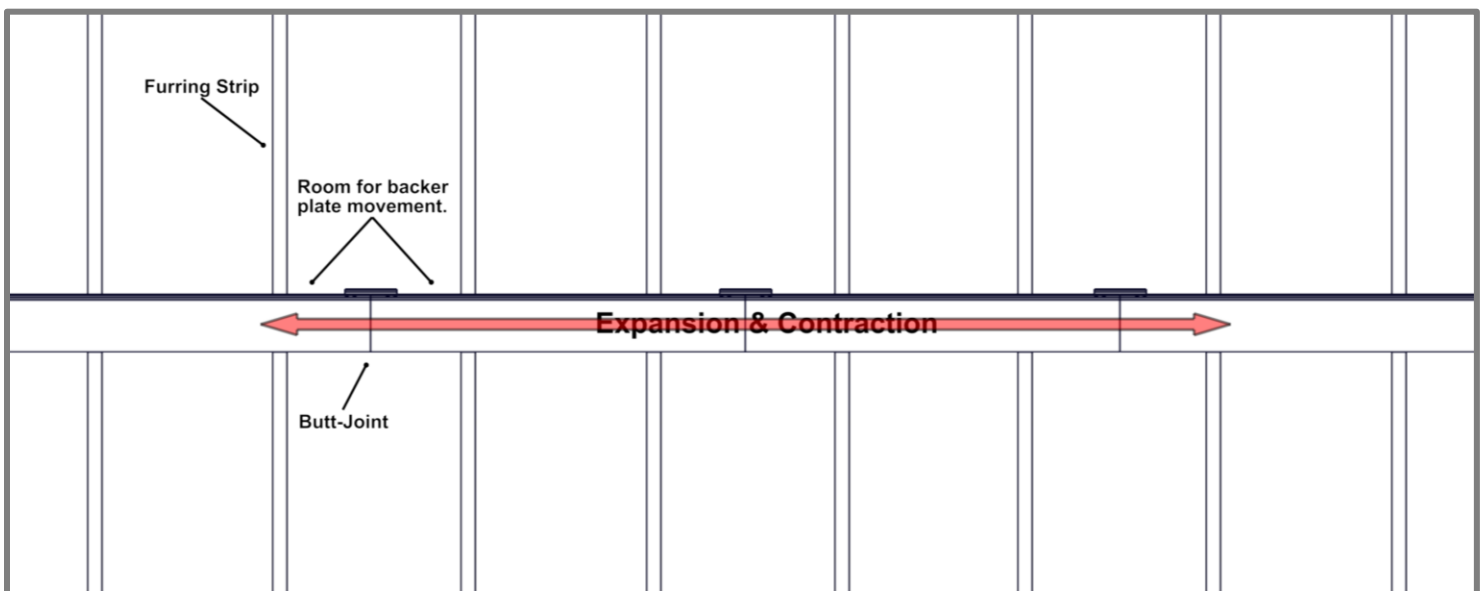

Detail E -Butt-Joint Movement

Appendix

Expansion and Contraction Tables

TABLE 1 - IMPERIAL

| | | AVERAGE TEMPERATURE AT TIME OF CUTTING & INSTALLATION | | | | | | | | | | | |
|---------------------------------|-----|---|--------------------------------------|--------|--------|--------|--------|--------|--------|--------|--------|--------|--------|
| | | °C | -50 | -40 | -30 | -20 | -10 | 0 | 10 | 20 | 30 | 40 | 50 |
| | | °F | -58 | -40 | -22 | -4 | 14 | 32 | 50 | 68 | 86 | 104 | 122 |
| MIN/MAX POST CONSTRUCTION TEMP. | °C | °F | EXPANSION OR CONTRACTION (INCH/FOOT) | | | | | | | | | | |
| | -50 | -58 | 0.000 | -0.003 | -0.005 | -0.008 | -0.011 | -0.014 | -0.016 | -0.019 | -0.022 | -0.024 | -0.027 |
| | -40 | -40 | 0.003 | 0.000 | -0.003 | -0.005 | -0.008 | -0.011 | -0.014 | -0.016 | -0.019 | -0.022 | -0.024 |
| | -30 | -22 | 0.005 | 0.003 | 0.000 | -0.003 | -0.005 | -0.008 | -0.011 | -0.014 | -0.016 | -0.019 | -0.022 |
| | -20 | -4 | 0.008 | 0.005 | 0.003 | 0.000 | -0.003 | -0.005 | -0.008 | -0.011 | -0.014 | -0.016 | -0.019 |
| | -10 | 14 | 0.011 | 0.008 | 0.005 | 0.003 | 0.000 | -0.003 | -0.005 | -0.008 | -0.011 | -0.014 | -0.016 |
| | 0 | 32 | 0.014 | 0.011 | 0.008 | 0.005 | 0.003 | 0.000 | -0.003 | -0.005 | -0.008 | -0.011 | -0.014 |
| | 10 | 50 | 0.016 | 0.014 | 0.011 | 0.008 | 0.005 | 0.003 | 0.000 | -0.003 | -0.005 | -0.008 | -0.011 |
| | 20 | 68 | 0.019 | 0.016 | 0.014 | 0.011 | 0.008 | 0.005 | 0.003 | 0.000 | -0.003 | -0.005 | -0.008 |
| | 30 | 86 | 0.022 | 0.019 | 0.016 | 0.014 | 0.011 | 0.008 | 0.005 | 0.003 | 0.000 | -0.003 | -0.005 |
| | 40 | 104 | 0.024 | 0.022 | 0.019 | 0.016 | 0.014 | 0.011 | 0.008 | 0.005 | 0.003 | 0.000 | -0.003 |
| | 50 | 122 | 0.027 | 0.024 | 0.022 | 0.019 | 0.016 | 0.014 | 0.011 | 0.008 | 0.005 | 0.003 | 0.000 |

TABLE 2 - METRIC

| | | AVERAGE TEMPERATURE AT TIME OF CUTTING & INSTALLATION | | | | | | | | | | | |
|---------------------------------|-----|---|-------------------------------------|--------|--------|--------|--------|--------|--------|--------|--------|--------|--------|
| | | °C | -50 | -40 | -30 | -20 | -10 | 0 | 10 | 20 | 30 | 40 | 50 |
| | | °F | -58 | -40 | -22 | -4 | 14 | 32 | 50 | 68 | 86 | 104 | 122 |
| MIN/MAX POST CONSTRUCTION TEMP. | °C | °F | EXPANSION OR CONTRACTION (MM/METER) | | | | | | | | | | |
| | -50 | -58 | 0.000 | -0.230 | -0.460 | -0.690 | -0.920 | -1.150 | -1.380 | -1.610 | -1.840 | -2.070 | -2.300 |
| | -40 | -40 | 0.230 | 0.000 | -0.230 | -0.460 | -0.690 | -0.920 | -1.150 | -1.380 | -1.610 | -1.840 | -2.070 |
| | -30 | -22 | 0.460 | 0.230 | 0.000 | -0.230 | -0.460 | -0.690 | -0.920 | -1.150 | -1.380 | -1.610 | -1.840 |
| | -20 | -4 | 0.690 | 0.460 | 0.230 | 0.000 | -0.230 | -0.460 | -0.690 | -0.920 | -1.150 | -1.380 | -1.610 |
| | -10 | 14 | 0.920 | 0.690 | 0.460 | 0.230 | 0.000 | -0.230 | -0.460 | -0.690 | -0.920 | -1.150 | -1.380 |
| | 0 | 32 | 1.150 | 0.920 | 0.690 | 0.460 | 0.230 | 0.000 | -0.230 | -0.460 | -0.690 | -0.920 | -1.150 |
| | 10 | 50 | 1.380 | 1.150 | 0.920 | 0.690 | 0.460 | 0.230 | 0.000 | -0.230 | -0.460 | -0.690 | -0.920 |
| | 20 | 68 | 1.610 | 1.380 | 1.150 | 0.920 | 0.690 | 0.460 | 0.230 | 0.000 | -0.230 | -0.460 | -0.690 |
| | 30 | 86 | 1.840 | 1.610 | 1.380 | 1.150 | 0.920 | 0.690 | 0.460 | 0.230 | 0.000 | -0.230 | -0.460 |
| | 40 | 104 | 2.070 | 1.840 | 1.610 | 1.380 | 1.150 | 0.920 | 0.690 | 0.460 | 0.230 | 0.000 | -0.230 |
| | 50 | 122 | 2.300 | 2.070 | 1.840 | 1.610 | 1.380 | 1.150 | 0.920 | 0.690 | 0.460 | 0.230 | 0.000 |

TABLE 3

| LONGBOARD [®] INSPIRING ARCHITECTURE | | WIND LOAD QUICK-SCREEN CLIP/FASTENING SPACING | | | | | | | | | | |
|--|-----|--|----|----|----|----|----|----|----|-----|-----|-----|
| STARTER STRIP w. 4" PLANK | | PSF (Factored / Ultimate) | | | | | | | | | | |
| | | 20 | 30 | 40 | 50 | 60 | 70 | 80 | 90 | 100 | 110 | 121 |
| QUICK-SCREEN CLIP SPACING (IN) 1, 2, 3 | 16" | Wood | | | | | | | | | | |
| | | 16ga | | | | | | | | | | |
| | | 18ga | | | | | | | | | | |
| | | 20ga | | | | | | | | | | |

All testing has been performed using L/180 deflection limits

Substrate Types: Sheathed Wood-Frame Wall w/2.0 in. lg. #10 Pan-head wood screws
 Sheathed 16ga, 50ksi Steel Stud Wall w/#10 Pan-Head Self-Drilling Screws
 Sheathed 18ga, 33ksi Steel Stud Wall w/#10 Pan-Head Self-Drilling Screws
 Sheathed 20ga, 33ksi Steel Stud Wall w/#10 Pan-Head Self-Drilling Screws

***Starter Strip requires Two (2) installation anchors at each fastener location:
 1 Quick-Screen Clip + 1 Mid-Point slotted hole**

1_Spacing is from clip center to center
 2_An unfactored dead load of 1.5 psf was assumed for the cladding
 3_If fastening to every second stud, the attachment stud shall be staggered between adjacent runs of cladding

**Position of Fastener
for Table 3 & 4**

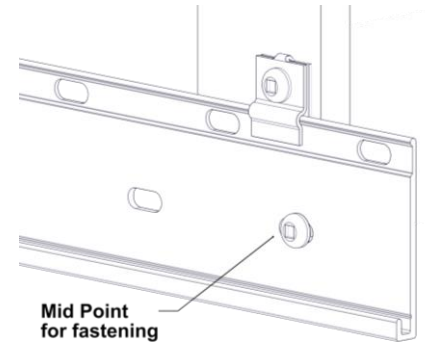

TABLE 4

| LONGBOARD [®] INSPIRING ARCHITECTURE | | WIND LOAD QUICK-SCREEN CLIP/FASTENING SPACING | | | | | | | | | | |
|--|-----|--|----|----|----|----|----|----|----|-----|-----|-----|
| STARTER STRIP w. 6" PLANK | | PSF (Factored / Ultimate) | | | | | | | | | | |
| | | 20 | 30 | 40 | 50 | 60 | 70 | 80 | 90 | 100 | 110 | 121 |
| QUICK-SCREEN CLIP SPACING (IN) 1, 2, 3 | 16" | Wood | | | | | | | | | | |
| | | 16ga | | | | | | | | | | |
| | | 18ga | | | | | | | | | | |
| | | 20ga | | | | | | | | | | |

All testing has been performed using L/180 deflection limits

Substrate Types: Sheathed Wood-Frame Wall w/2.0 in. lg. #10 Pan-head wood screws
 Sheathed 16ga, 50ksi Steel Stud Wall w/#10 Pan-Head Self-Drilling Screws
 Sheathed 18ga, 33ksi Steel Stud Wall w/#10 Pan-Head Self-Drilling Screws
 Sheathed 20ga, 33ksi Steel Stud Wall w/#10 Pan-Head Self-Drilling Screws

***Starter Strip requires Two (2) installation anchors at each fastener location:
 1 Quick-Screen Clip + 1 Mid-Point slotted hole**

1_Spacing is from clip center to center
 2_An unfactored dead load of 1.5 psf was assumed for the cladding
 3_If fastening to every second stud, the attachment stud shall be staggered between adjacent runs of cladding

TABLE 5

| 2" LINK & LOCK | | PSF (FACTORED/ULTIMATE) | | | | | | | | | | |
|---------------------|-----|-------------------------|----|----|----|----|----|----|-----|-----|-----|---|
| | | 30 | 40 | 50 | 60 | 70 | 80 | 90 | 100 | 110 | 120 | |
| ALLOWABLE SPAN (ft) | 4' | ✓ | ✓ | ✓ | ✓ | ✓ | ✓ | ✓ | ✓ | ✓ | ✓ | ✓ |
| | 6' | ✓ | ✓ | ✓ | ✓ | ✓ | ✓ | ✓ | ✓ | ✓ | ✓ | ✓ |
| | 8' | ✓ | ✓ | ✓ | ✓ | ✓ | ✓ | ✓ | ✓ | ✓ | ✓ | ✓ |
| | 10' | ✓ | ✓ | ✓ | ✓ | ✓ | ✓ | ✓ | ✓ | ✓ | ✓ | ✓ |

All testing has been performed using L/180 deflection limits

TABLE 6

| 4" LINK & LOCK | | PSF (FACTORED/ULTIMATE) | | | | | | | | | | |
|---------------------|----|-------------------------|----|----|----|----|----|----|-----|-----|-----|---|
| | | 30 | 40 | 50 | 60 | 70 | 80 | 90 | 100 | 110 | 120 | |
| ALLOWABLE SPAN (ft) | 2' | ✓ | ✓ | ✓ | ✓ | ✓ | ✓ | ✓ | ✓ | ✓ | ✓ | ✓ |
| | 4' | ✓ | ✓ | ✓ | ✓ | ✓ | ✓ | ✓ | ✓ | ✓ | ✓ | ✓ |
| | 6' | ✓ | ✓ | ✓ | ✓ | ✓ | ✓ | ✓ | ✓ | ✓ | ✓ | ✓ |
| | 8' | ✓ | ✓ | ✓ | ✓ | ✓ | ✓ | ✓ | ✓ | ✓ | ✓ | ✓ |

All testing has been performed using L/180 deflection limits

TABLE 7

| 6" LINK & LOCK | | PSF (FACTORED/ULTIMATE) | | | | | | | | | | |
|---------------------|----|-------------------------|----|----|----|----|----|----|-----|-----|-----|---|
| | | 30 | 40 | 50 | 60 | 70 | 80 | 90 | 100 | 110 | 120 | |
| ALLOWABLE SPAN (ft) | 2' | ✓ | ✓ | ✓ | ✓ | ✓ | ✓ | ✓ | ✓ | ✓ | ✓ | ✓ |
| | 4' | ✓ | ✓ | ✓ | ✓ | ✓ | ✓ | ✓ | ✓ | ✓ | ✓ | ✓ |
| | 6' | ✓ | ✓ | ✓ | ✓ | ✓ | ✓ | ✓ | ✓ | ✓ | ✓ | ✓ |

All testing has been performed using L/180 deflection limits

TABLE 8

| 8" LINK & LOCK | | PSF (FACTORED/ULTIMATE) | | | | | | | | | | |
|---------------------|----|-------------------------|----|----|----|----|----|----|-----|-----|-----|---|
| | | 30 | 40 | 50 | 60 | 70 | 80 | 90 | 100 | 110 | 120 | |
| ALLOWABLE SPAN (ft) | 2' | ✓ | ✓ | ✓ | ✓ | ✓ | ✓ | ✓ | ✓ | ✓ | ✓ | ✓ |
| | 4' | ✓ | ✓ | ✓ | ✓ | ✓ | ✓ | ✓ | ✓ | ✓ | ✓ | ✓ |
| | 6' | ✓ | ✓ | ✓ | ✓ | ✓ | ✓ | ✓ | ✓ | ✓ | ✓ | ✓ |

All testing has been performed using L/180 deflection limits

Proper Handling of Longboard Products



To help avoid injury and product damage, Longboard products require proper handling to and from storage areas during installation. When carrying or installing any products it is recommended that they be moved or carried by at least two people with each support point approximately 4ft from the ends. **Carrying products without proper support can cause excessive bending which may damage the appearance or finish of the product.** Any short cut lengths should also be carried on edge while supporting the material. See below for details.

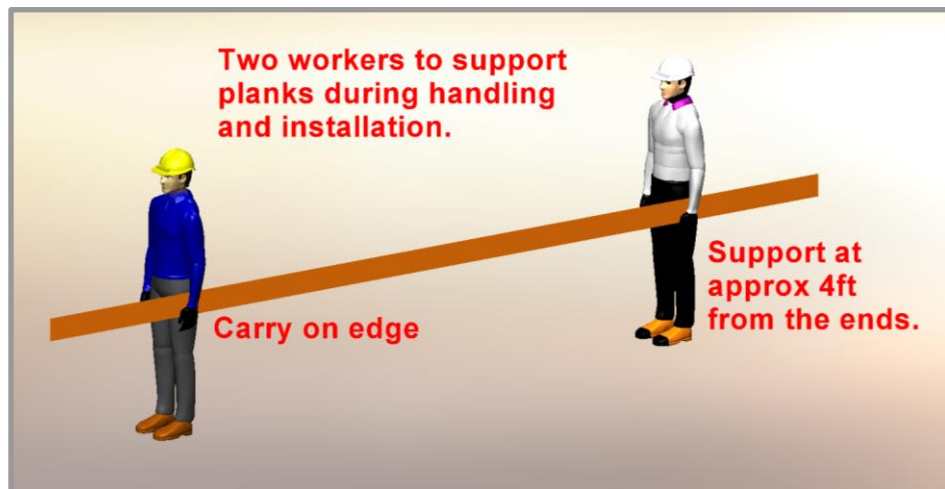
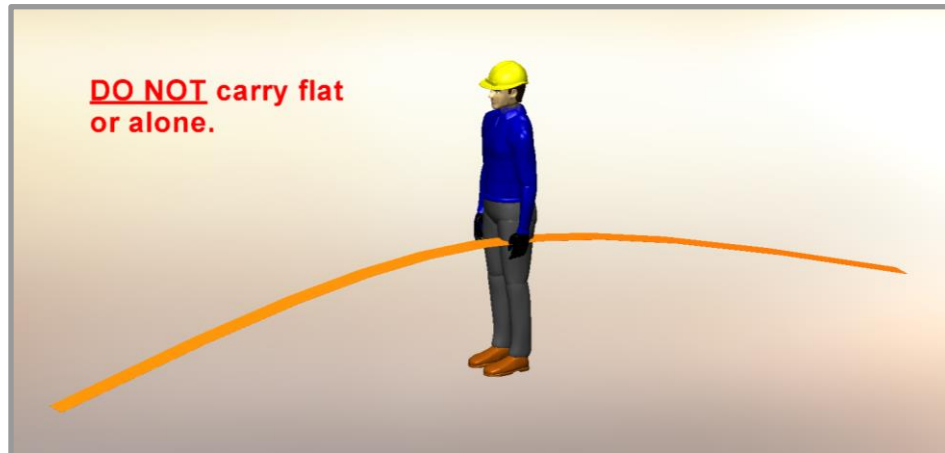

⚠️ Delivery, Storage & Handling ⚠️

- Always inspect the delivery for damage and contact LB ASAP if there are any issues: info@longboardproducts.com or 1-800-604-0343 and include your PO# and any pictures if possible. Longboard is not responsible for the installation of blemished or damaged material.
- Be sure to store the material flat, keep it dry, safe & secure and remain in unopened cartons until ready to be installed.
- Always wear appropriate PPE when handling products.

BLANK PAGE



Longboard Architectural Products Inc.
© Longboard Architectural Products Inc. All rights reserved.

Longboard® is a registered trademark of Longboard Architectural Products Inc.

Longboard
1777 Clearbrook Road
Abbotsford, BC V2T 8X8
Canada
longboardproducts.com

Every effort has been made to ensure that the information in these installation guidelines are accurate. Longboard is not responsible for printing or clerical errors.

For more information, contact client care at info@longboardproducts.com or call toll free 1-800-604-0343.