

DAUNTLESS BAFFLE PROFILES

TABLE OF CONTENT

(Click on the drawing name below to be directed to the right profile)

[1-5/8" X 4" DAUNTLESS BAFFLE](#)

[1-5/8" X 6" DAUNTLESS BAFFLE](#)

[1-5/8" DAUNTLESS BAFFLE END CAP - 4"](#)

[1-5/8" DAUNTLESS BAFFLE END CAP - 6"](#)

[DAUNTLESS SPLINE](#)

[SINGLE CARRIER RAIL](#)

[DOUBLE CARRIER RAIL](#)

[HANGER CLIP - 3"](#)

[HANGER CLIP SINGLE - 1-1/2"](#)

[SIDE CARRIER RAIL](#)

[HANGER BRACKET](#)

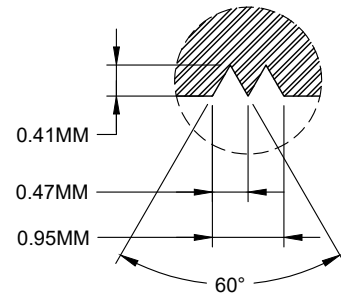

① PERMANENT MANUFACTURER MARKING
SCALE: 10:1

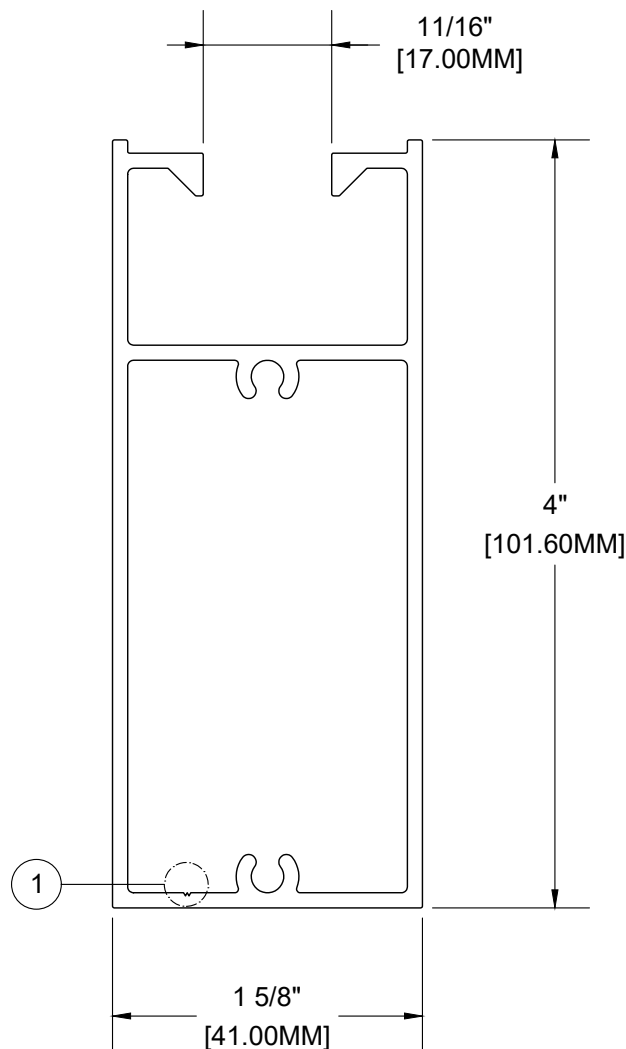

These drawings are published as an information guide only. These CAD drawings are intended as templates to assist the designer, they do not contain the full detail required for construction and must be read in conjunction with the installation instructions on www.longboardproducts.com. You should obtain architectural, engineering or other technical advice to assess the suitability of these drawings to the requirements of your particular project. Longboard Architectural Products accepts no liability in respect to the use of these drawings. For complete installation instructions refer to the appropriate documentation here www.longboardproducts.com/resources/technical-documentation/installation-guides

1-5/8" X 4" DAUNTLESS BAFFLE
ALUMINUM ALLOY: 6063-T5
WEIGHT: 1.19 LBS/ LF
SCALE: 1:1



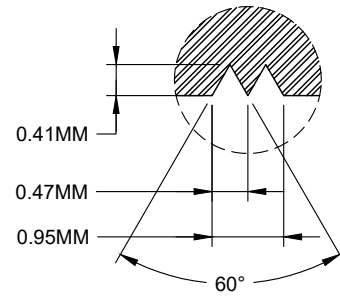
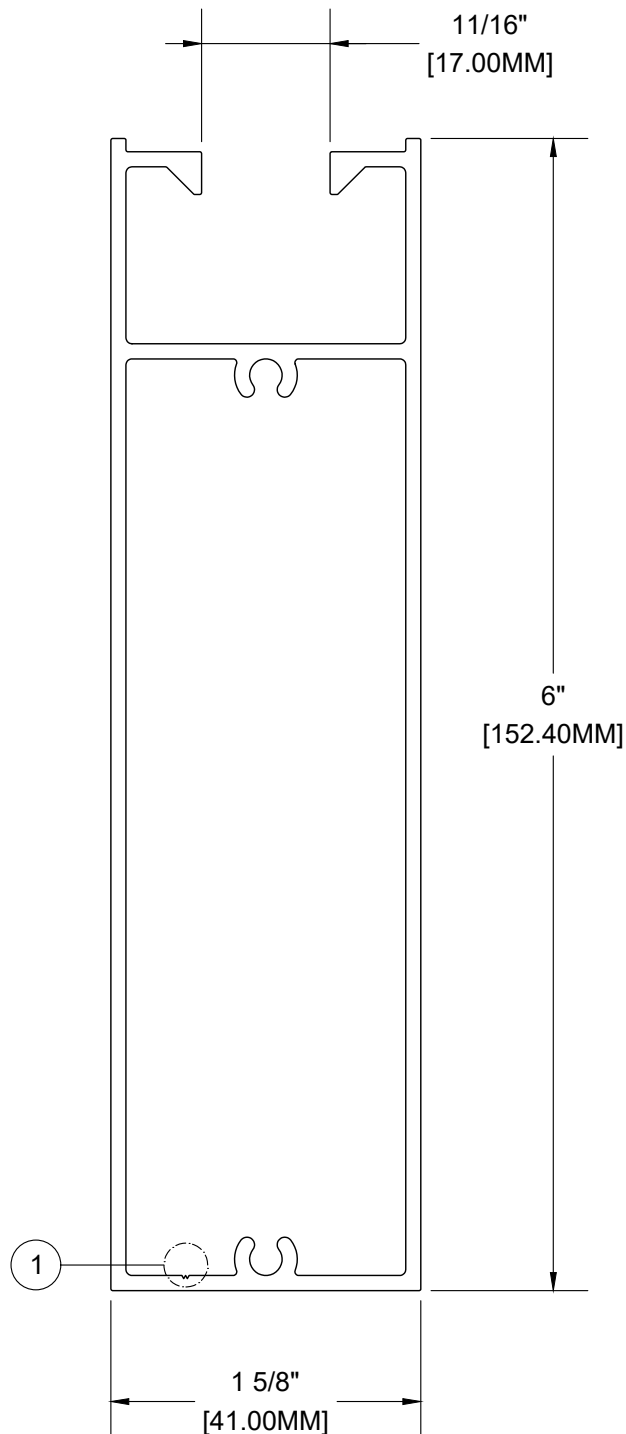

① PERMANENT MANUFACTURER MARKING
SCALE: 10:1

These drawings are published as an information guide only. These CAD drawings are intended as templates to assist the designer, they do not contain the full detail required for construction and must be read in conjunction with the installation instructions on www.longboardproducts.com. You should obtain architectural, engineering or other technical advice to assess the suitability of these drawings to the requirements of your particular project. Longboard Architectural Products accepts no liability in respect to the use of these drawings. For complete installation instructions refer to the appropriate documentation here www.longboardproducts.com/resources/technical-documentation/installation-guides

1-5/8" X 6" DAUNTLESS BAFFLE
ALUMINUM ALLOY: 6063-T5
WEIGHT: 1.57 LBS/ LF
SCALE: 1:1



ISSUE DATE: 2025-07-16

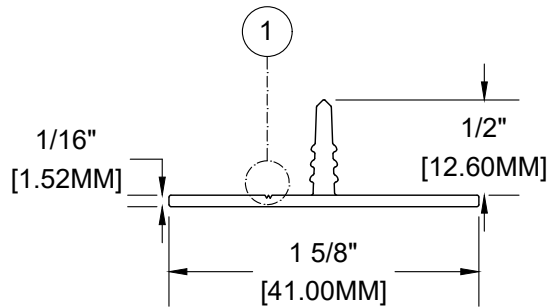

TOP VIEW

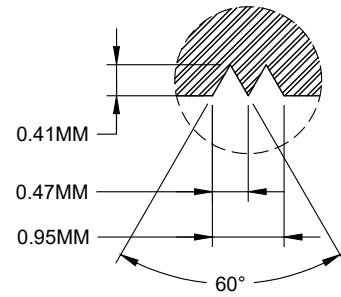

① PERMANENT MANUFACTURER MARKING
SCALE: 10:1

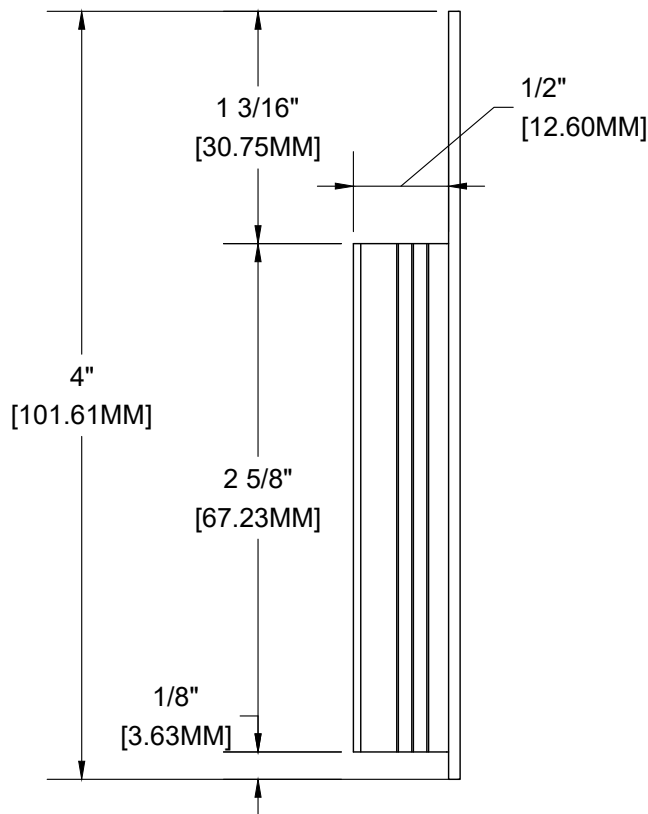

SIDE VIEW

These drawings are published as an information guide only. These CAD drawings are intended as templates to assist the designer, they do not contain the full detail required for construction and must be read in conjunction with the installation instructions on www.longboardproducts.com. You should obtain architectural, engineering or other technical advice to assess the suitability of these drawings to the requirements of your particular project. Longboard Architectural Products accepts no liability in respect to the use of these drawings. For complete installation instructions refer to the appropriate documentation here www.longboardproducts.com/resources/technical-documentation/installation-guides

1-5/8" DAUNTLESS BAFFLE END CAP - 4"

ALUMINUM ALLOY: 6063-T5

WEIGHT: 0.05 LBS

SCALE: 1:1



ISSUE DATE: 2025-07-16

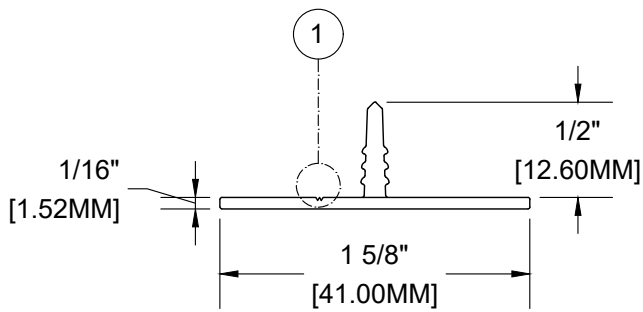

TOP VIEW

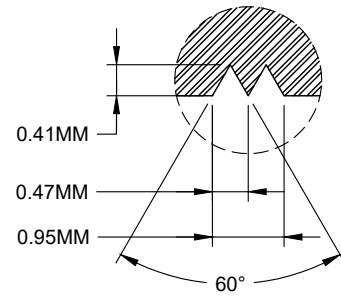

1

PERMANENT MANUFACTURER MARKING
SCALE: 10:1

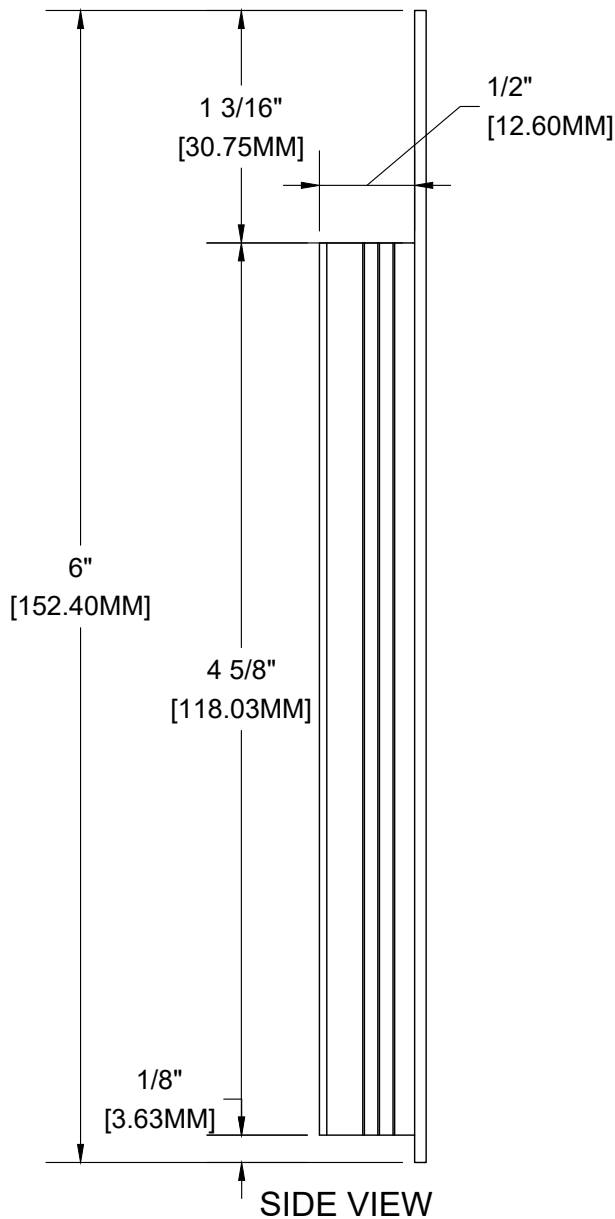

SIDE VIEW

These drawings are published as an information guide only. These CAD drawings are intended as templates to assist the designer, they do not contain the full detail required for construction and must be read in conjunction with the installation instructions on www.longboardproducts.com. You should obtain architectural, engineering or other technical advice to assess the suitability of these drawings to the requirements of your particular project. Longboard Architectural Products accepts no liability in respect to the use of these drawings. For complete installation instructions refer to the appropriate documentation here www.longboardproducts.com/resources/technical-documentation/installation-guides

1-5/8" DAUNTLESS BAFFLE END CAP - 6"

ALUMINUM ALLOY: 6063-T5

WEIGHT: 0.08 LBS

SCALE: 1:1



ISSUE DATE: 2025-07-16

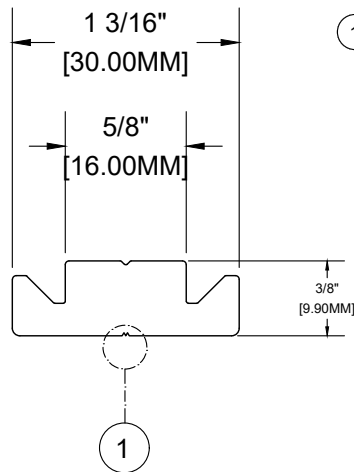
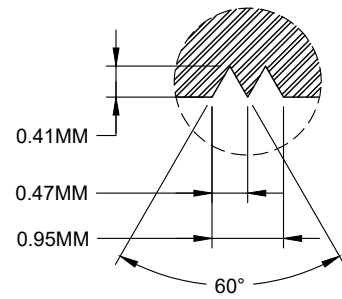

1 PERMANENT MANUFACTURER MARKING
SCALE: 10:1

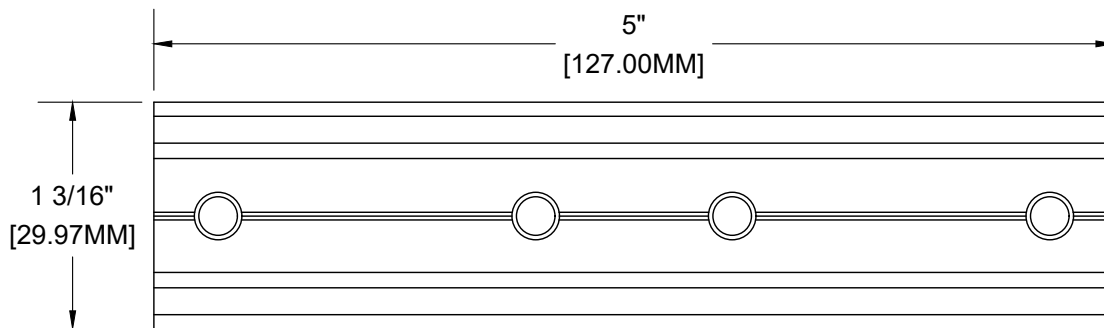

These drawings are published as an information guide only. These CAD drawings are intended as templates to assist the designer, they do not contain the full detail required for construction and must be read in conjunction with the installation instructions on www.longboardproducts.com. You should obtain architectural, engineering or other technical advice to assess the suitability of these drawings to the requirements of your particular project. Longboard Architectural Products accepts no liability in respect to the use of these drawings. For complete installation instructions refer to the appropriate documentation here www.longboardproducts.com/resources/technical-documentation/installation-guides

DAUNTLESS SPLINE
ALUMINUM ALLOY: 6063-T5
WEIGHT: 0.44 LBS/LF
SCALE: 1:1



ISSUE DATE: 2025-07-16

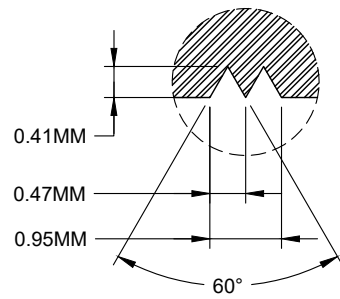

① PERMANENT MANUFACTURER MARKING
SCALE: 10:1

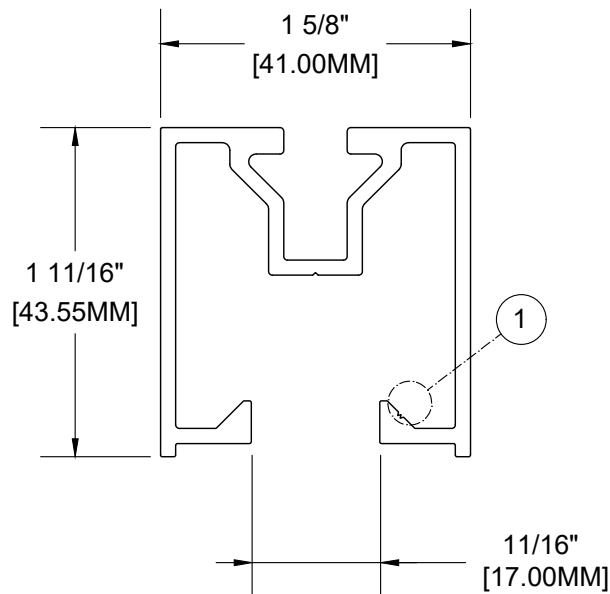

These drawings are published as an information guide only. These CAD drawings are intended as templates to assist the designer, they do not contain the full detail required for construction and must be read in conjunction with the installation instructions on www.longboardproducts.com. You should obtain architectural, engineering or other technical advice to assess the suitability of these drawings to the requirements of your particular project. Longboard Architectural Products accepts no liability in respect to the use of these drawings. For complete installation instructions refer to the appropriate documentation here www.longboardproducts.com/resources/technical-documentation/installation-guides

SINGLE CARRIER RAIL
ALUMINUM ALLOY: 6063-T5
WEIGHT: 0.733 LBS/ LF
SCALE: 1:1



ISSUE DATE: 2025-07-16

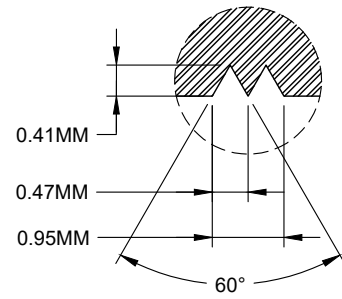

① PERMANENT MANUFACTURER MARKING
SCALE: 10:1

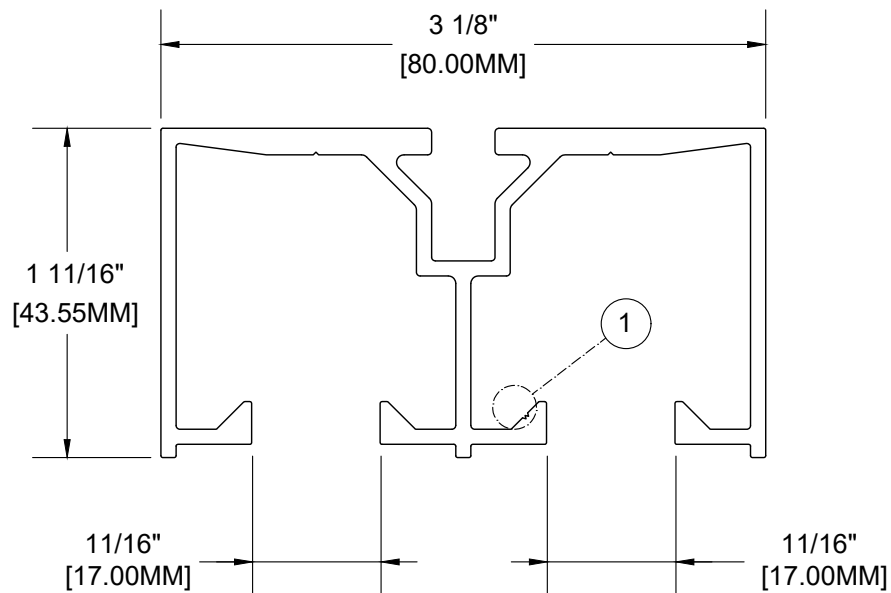

These drawings are published as an information guide only. These CAD drawings are intended as templates to assist the designer, they do not contain the full detail required for construction and must be read in conjunction with the installation instructions on www.longboardproducts.com. You should obtain architectural, engineering or other technical advice to assess the suitability of these drawings to the requirements of your particular project. Longboard Architectural Products accepts no liability in respect to the use of these drawings. For complete installation instructions refer to the appropriate documentation here www.longboardproducts.com/resources/technical-documentation/installation-guides

DOUBLE CARRIER RAIL
ALUMINUM ALLOY: 6063-T5
WEIGHT: 1.189 LBS/ LF
SCALE: 1:1



ISSUE DATE: 2025-07-16

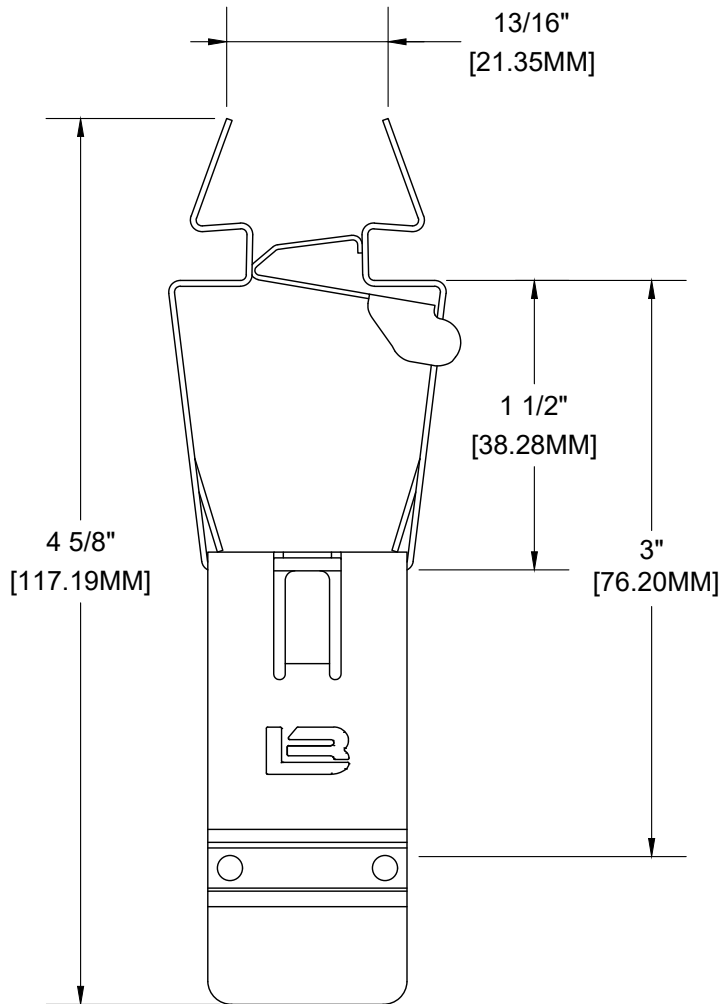

FRONT VIEW

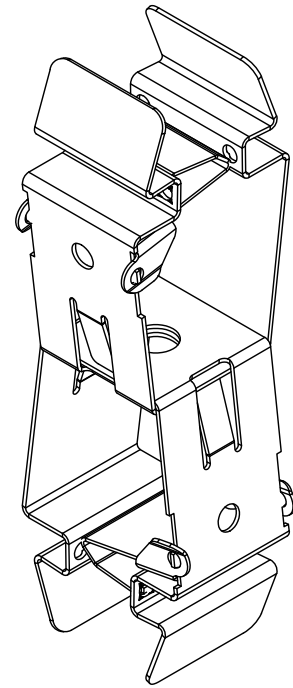

ISOMETRIC VIEW

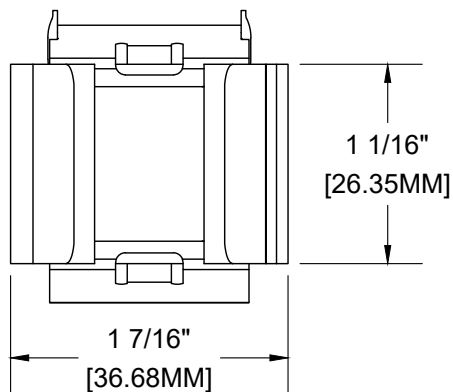

TOP VIEW

These drawings are published as an information guide only. These CAD drawings are intended as templates to assist the designer, they do not contain the full detail required for construction and must be read in conjunction with the installation instructions on www.longboardproducts.com. You should obtain architectural, engineering or other technical advice to assess the suitability of these drawings to the requirements of your particular project. Longboard Architectural Products accepts no liability in respect to the use of these drawings. For complete installation instructions refer to the appropriate documentation here www.longboardproducts.com/resources/technical-documentation/installation-guides

HANGER CLIP - 3"
MATERIAL: STAINLESS STEEL
WEIGHT: 0.070 LBS
SCALE: 1:1



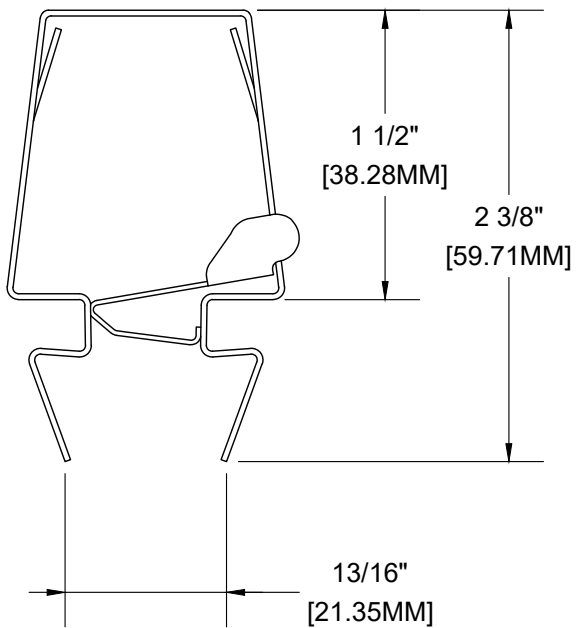

FRONT VIEW

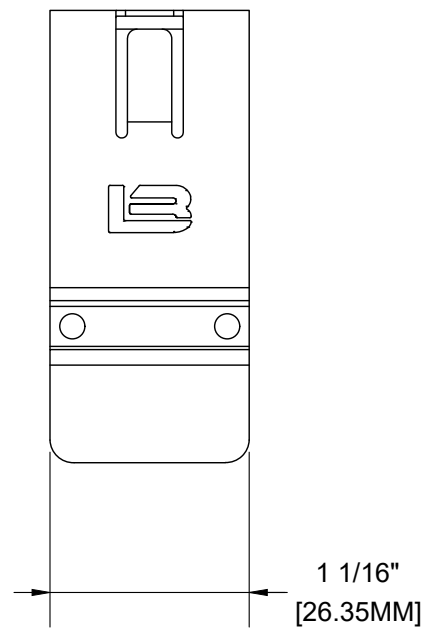

SIDE VIEW

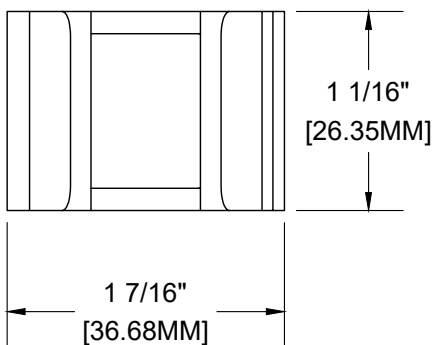

TOP VIEW

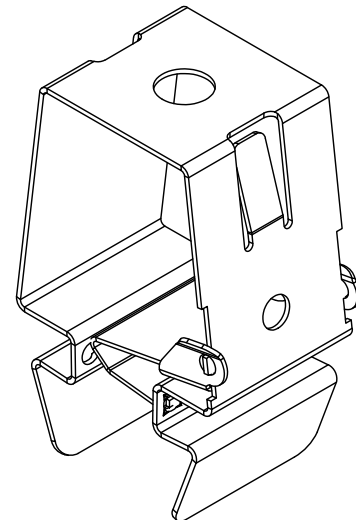

ISOMETRIC VIEW

These drawings are published as an information guide only. These CAD drawings are intended as templates to assist the designer, they do not contain the full detail required for construction and must be read in conjunction with the installation instructions on www.longboardproducts.com. You should obtain architectural, engineering or other technical advice to assess the suitability of these drawings to the requirements of your particular project. Longboard Architectural Products accepts no liability in respect to the use of these drawings. For complete installation instructions refer to the appropriate documentation here www.longboardproducts.com/resources/technical-documentation/installation-guides

HANGER CLIP SINGLE - 1-1/2"

MATERIAL: STAINLESS STEEL

WEIGHT: 0.070 LBS

SCALE: 1:1



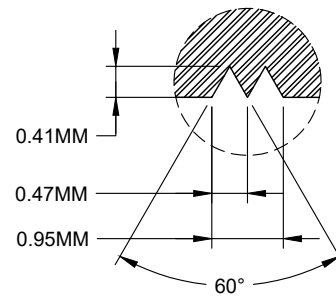

1 PERMANENT MANUFACTURER MARKING
SCALE: 10:1

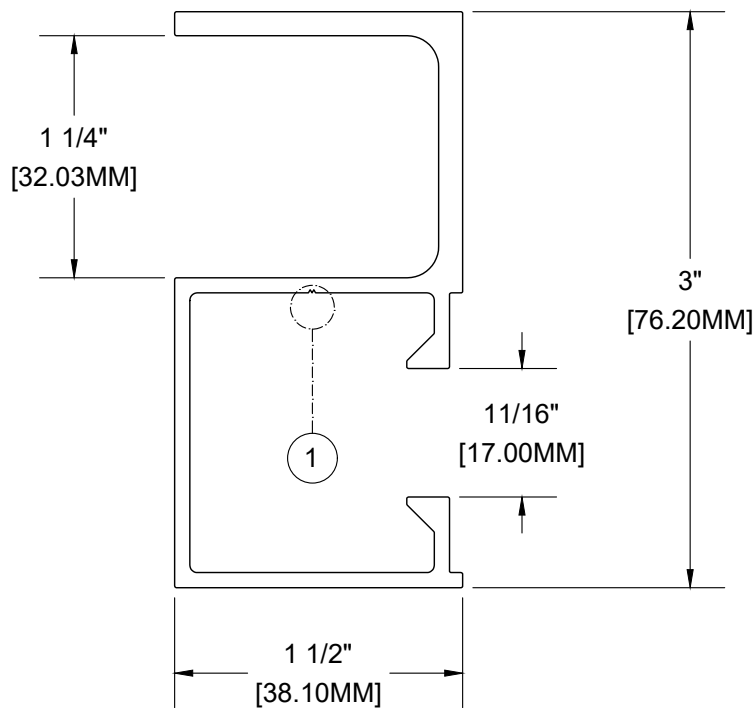

These drawings are published as an information guide only. These CAD drawings are intended as templates to assist the designer, they do not contain the full detail required for construction and must be read in conjunction with the installation instructions on www.longboardproducts.com. You should obtain architectural, engineering or other technical advice to assess the suitability of these drawings to the requirements of your particular project. Longboard Architectural Products accepts no liability in respect to the use of these drawings. For complete installation instructions refer to the appropriate documentation here www.longboardproducts.com/resources/technical-documentation/installation-guides

SIDE CARRIER RAIL
ALUMINUM ALLOY: 6063-T5
WEIGHT: 0.94 LBS/ LF
SCALE: 1:1



ISSUE DATE: 2025-07-16

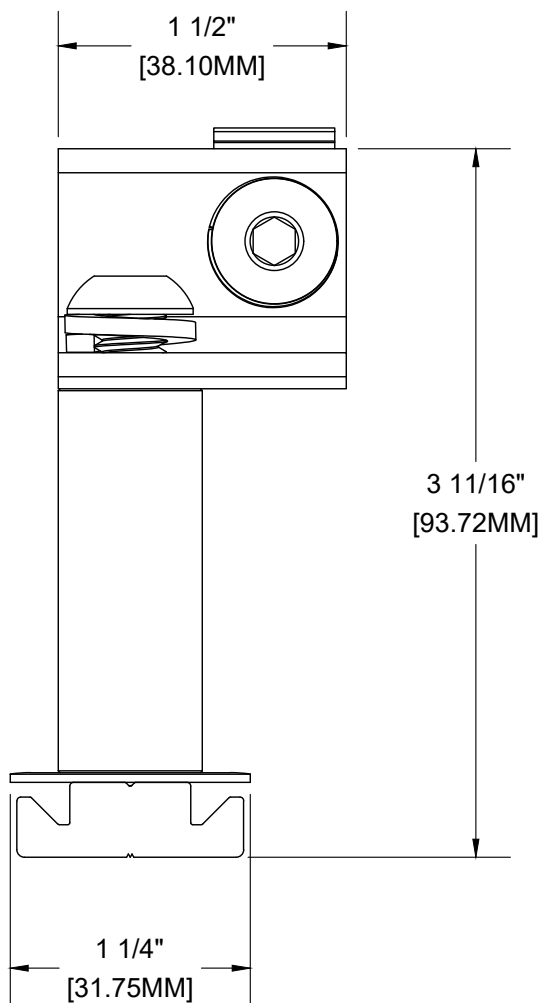

FRONT VIEW

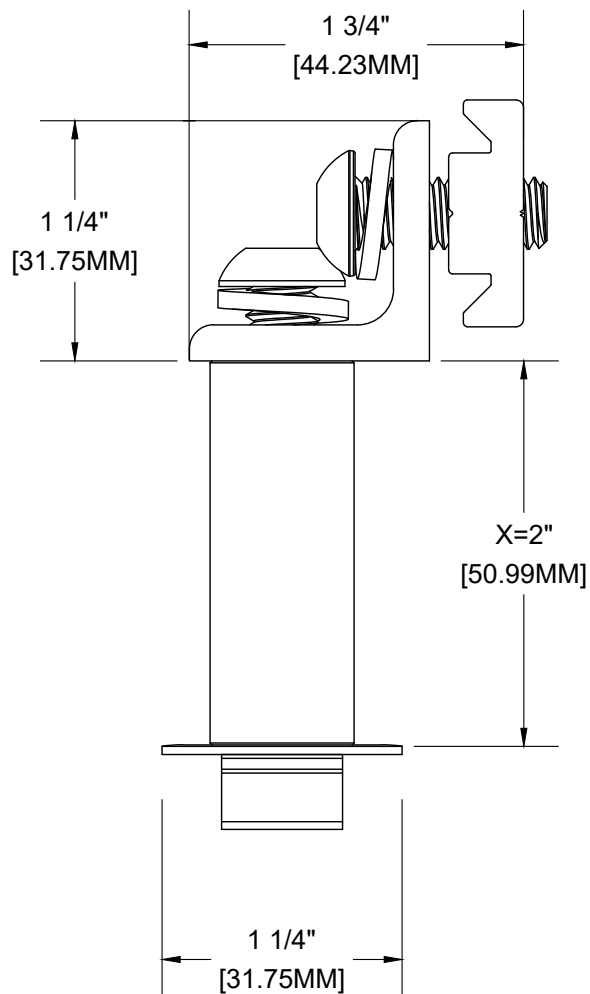

SIDE VIEW

* HANGER BRACKETS LENGTH (X) VARIES FROM 2" TO UPTO 12".

These drawings are published as an information guide only. These CAD drawings are intended as templates to assist the designer, they do not contain the full detail required for construction and must be read in conjunction with the installation instructions on www.longboardproducts.com. You should obtain architectural, engineering or other technical advice to assess the suitability of these drawings to the requirements of your particular project.
Longboard Architectural Products accepts no liability in respect to the use of these drawings. For complete installation instructions refer to the appropriate documentation here www.longboardproducts.com/resources/technical-documentation/installation-guides

HANGER BRACKET
MATERIALS: 6063-T5 ALUMINUM &
304 STAINLESS STEEL
WEIGHT: 0.277 LBS
SCALE: 1:1

